

PWB Series

Brass Free flow, valveless pressure washer couplers

Introduction

AKJIA's PWB Series couplers are able to accommodate high flow rates and minimal pressure drops. The couplers are valveless, hence when disconnected any fluid in the system can escape. This makes these couplers suitable for the transmission of non-hazardous fluids only.

Construction

- Brass body material good corrosion resistance
- Fitted with Nitrile seals - NBR

Features

- Valveless design allows for high flow rates and minimal pressure drop characteristics
- Female half has double 'O' ring sealing arrangement
- Bidirectional flow

Application

- Designed for use in pressure washer systems and systems containing non-hazardous fluids



Product Number Naming Rules

PWB- 10 F NPT 3/8

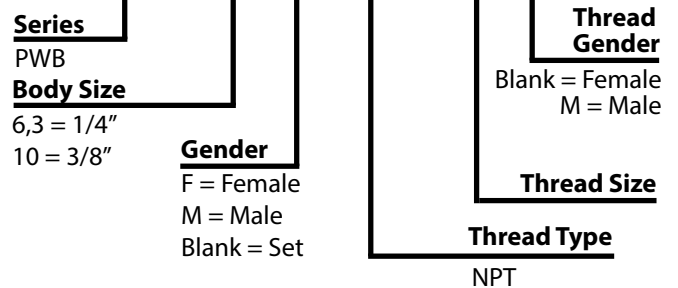

Specifications

Seal Material	Min. Temp		Max. Temp	
	-20°C	-4°F	200°C	392°F
FKM (Viton) seals	-20°C	-4°F	200°C	392°F

Drawing

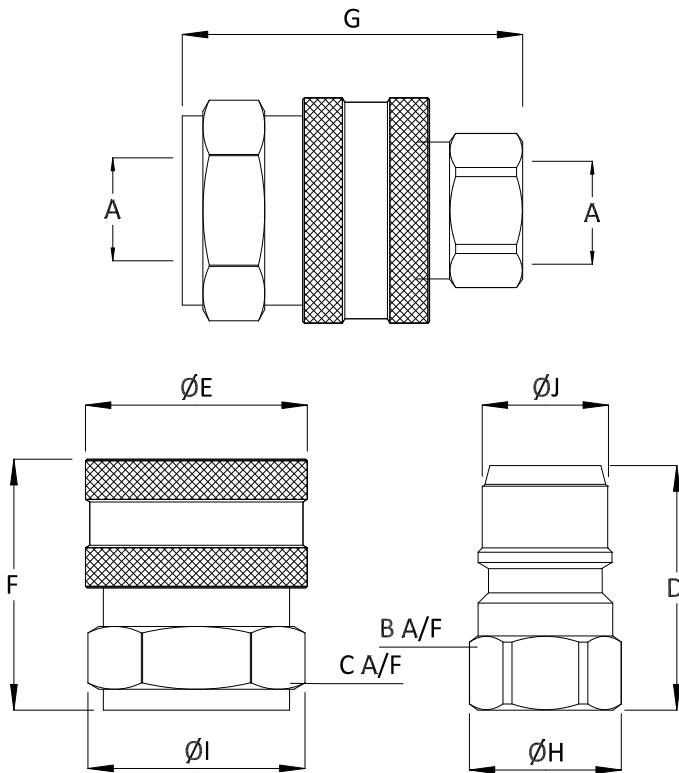

Pressure Drop Characteristics

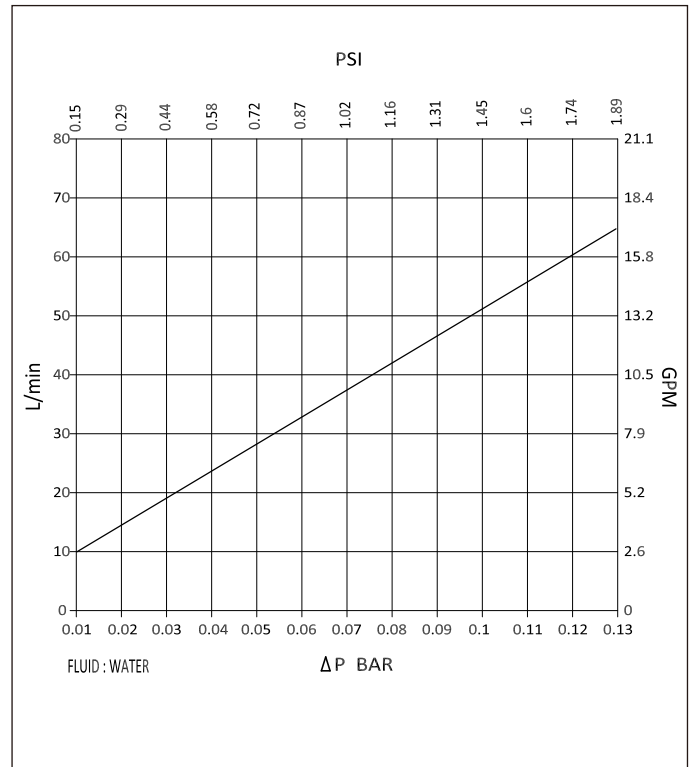

Size	Thread Size (A)	B	C	D	ØE	F	G	ØH	ØI	ØJ	Maximum Working Pressure	Burst Pressure (coupled)
		Dimensions in mm									Bar	
		Dimensions in inches									Psi	
PWB-10	3/8"	22	30	38	35	39	53.5	24	34.5	20	350	1500
		0.9	1.2	1.5	1.4	1.5	2.1	0.9	1.4	0.8	5075	21750