

PWS Series

Stainless steel pressure washer couplers

Introduction

AKJia's PWS Series stainless steel, pressure washer couplers are able to accommodate high flow rates and minimal pressure drops. The couplers are valveless, hence when disconnected any fluid in the system can escape. This makes these couplers suitable for the transmission of non-hazardous fluids only.

Construction

- AISI 316 stainless steel
- Fitted with Viton seals
- Also available in Brass (See PWB Series)

Features

- Valveless design allows for high flow rates and minimal pressure drop characteristics
- Female half has double 'O' ring sealing arrangement
- Bidirectional flow

Application

- Designed for use in pressure washer systems and systems containing non-hazardous fluids

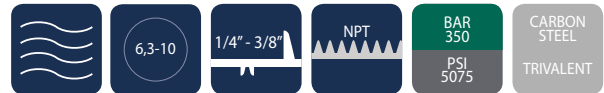

Product Number Naming Rules

PWS- 10 F NPT 3/8

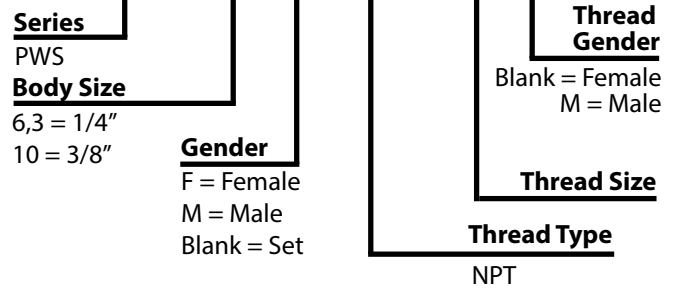

Specifications

Seal Material	Min. Temp		Max. Temp	
	-20°C	-4°F	200°C	392°F
FKM (Viton) seals	-20°C	-4°F	200°C	392°F

Drawing

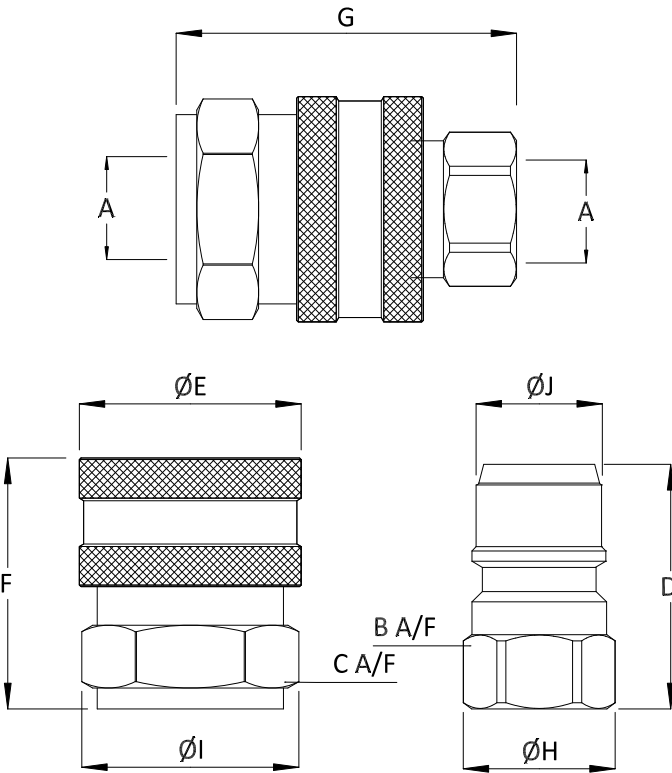

Pressure Drop Characteristics

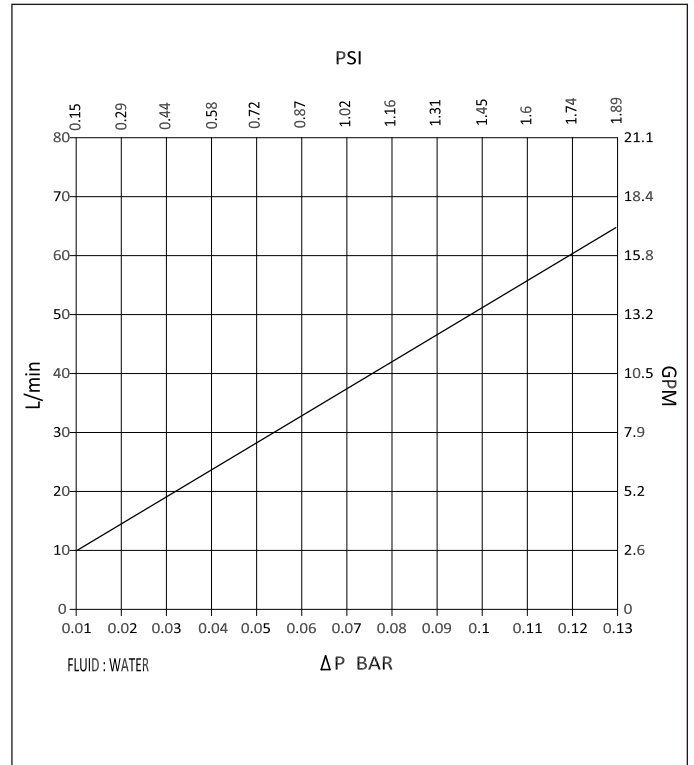

Size	Thread Size (A)	B	C	D	ØE	F	G	ØH	ØI	ØJ	Maximum Working Pressure	Burst Pressure (coupled)
Dimensions in mm											Bar	
Dimensions in inches											Psi	
PWS-10	3/8"	22	30	38	35	39	53.5	24	34.5	20	350	1300
		0.9	1.2	1.5	1.4	1.5	2.1	0.9	1.4	0.8	5075	18850