

DTP Series

Diagnostic test point couplings made to the ISO 15171-1 and SAE J1502 standards

Introduction

AKJia's DTP Series diagnostic test point couplers are designed to connect & disconnect pressure gauges to hydraulic systems for diagnostic purposes.

Construction

- Carbon steel with trivalent plating
- Fitted with Nitrile seals - NBR

Features

- Pull sleeve allows push to connect operation
- Allows for minimal inclusion of air and contaminants during connection
- Flat face design prevents fluid loss during disconnection
- Bidirectional flow

Application

- Pressure testing on hydraulic systems

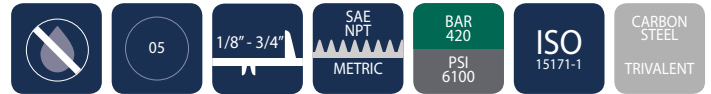

Product Number Naming Rules

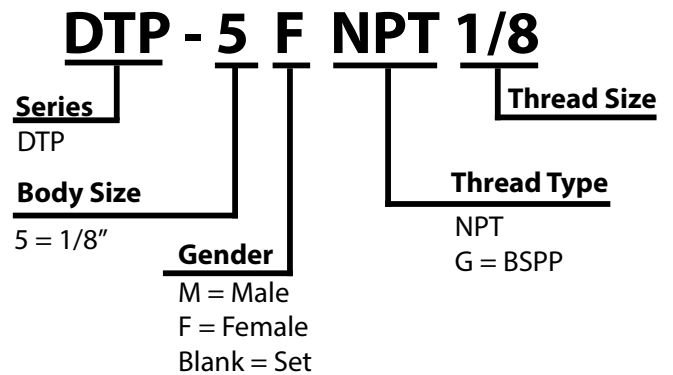

Specifications

Seal Material	Min. Temp		Max. Temp	
Nitrile seals*	-40°C	-40°F	106°C	223°F

Drawing

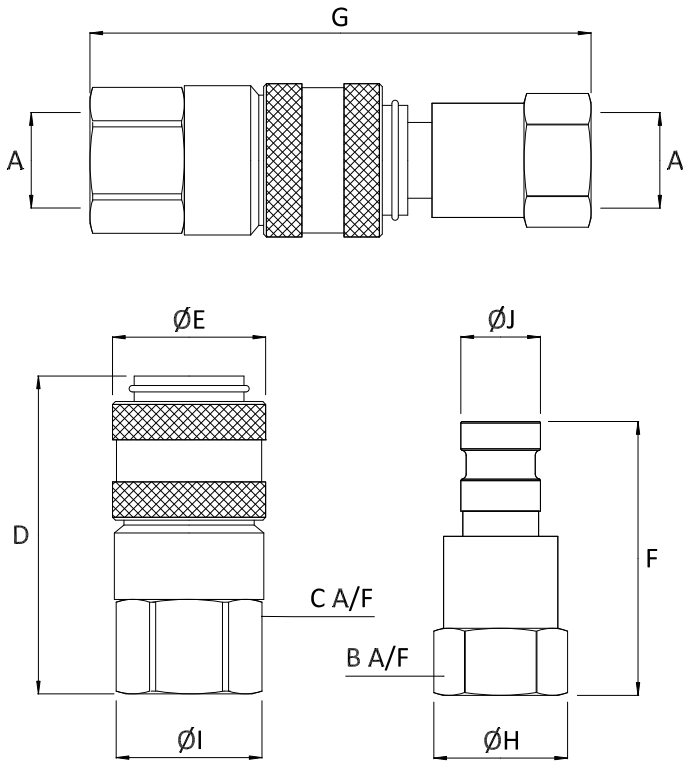

Pressure Drop Characteristics

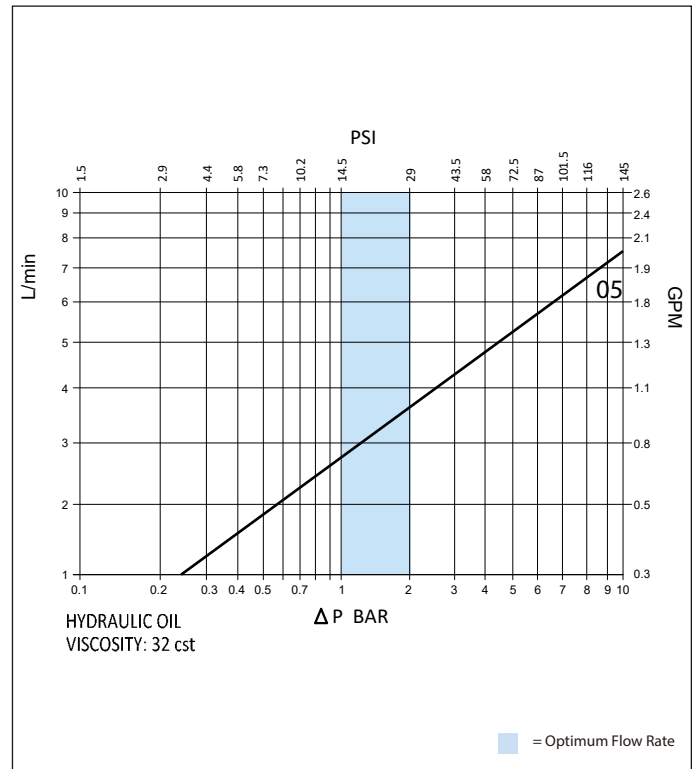

Size	Thread Size (A)	B	C	D	ØE	F	G	ØH	ØI	ØJ	Maximum Working Pressure
Dimensions in mm											bar
Dimensions in inches											psi
DTP-05	1/8"	18.9	21	45.6	24.1	43	74.2	21	23	12.6	400
		0.7	0.8	1.8	0.9	1.7	2.9	0.8	0.9	0.5	5800
DTP-05	1/4"	18.9	21	50	24.1	43.1	78.9	21	23	12.6	400
		0.7	0.8	2	0.9	1.7	3.1	0.8	0.9	0.5	5800
DTP-05	3/16"	18.9	21	50	24.1	43.1	78.9	21	23	12.6	400
		0.7	0.8	2	0.9	1.7	3.1	0.8	0.9	0.5	5800