

HJP|HJB Series

High pressure screw connect poppet & ball couplers made to the ISO 14540 Standard

Introduction

AKJia's HJP & HJB Series screw connect couplers are designed primarily for high pressure applications. They can be connected under low residual system pressures. The couplers are available with ball or poppet style valves.

Construction

- Carbon steel with trivalent plating
- Fitted with Polyurethane & Nitrile seals
- Option Carbon steel with zinc nickel plating (500 hours with no red rust in salt spray tests)

Features

- Screw connect design eliminates brinelling
- HJP offers poppet style valve
- HJB offers ball style valve
- Can be connected with low residual pressure in the hydraulic circuit
- Bidirectional flow

Application

- High pressure applications (Up to 700 bar for HJB and 1000 bar for HJP)
- General industrial, construction plant, mobile equipment, demolition and agricultural industries
- Hydraulic jacks
- Torque wrenches



Specifications

Seal Material	Min. Temp		Max. Temp	
Nitrile seals*	-40°C	-40°F	106°C	223°F



Product Number Naming Rules

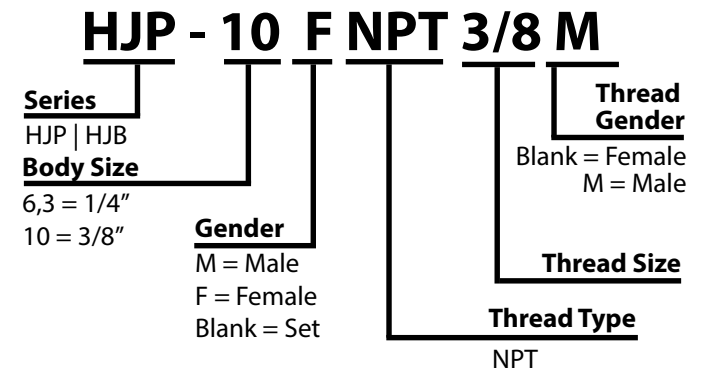

Drawing

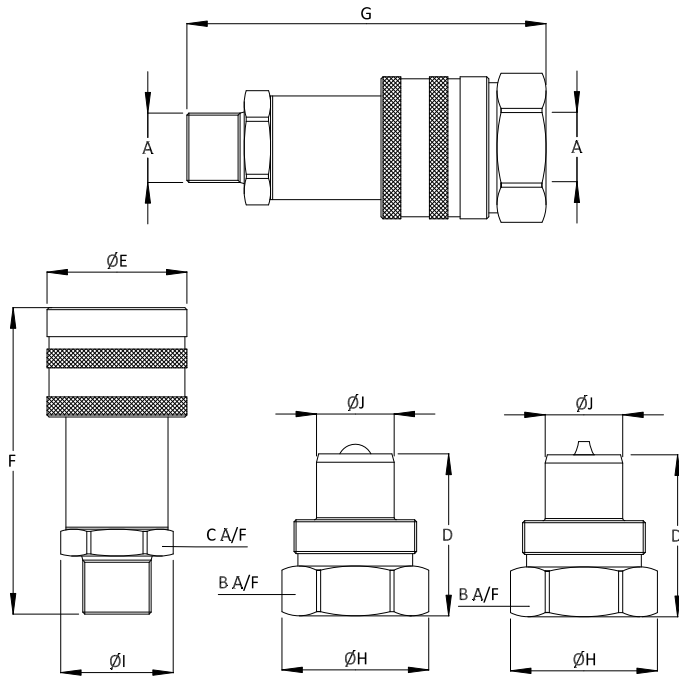

Pressure Drop Characteristics

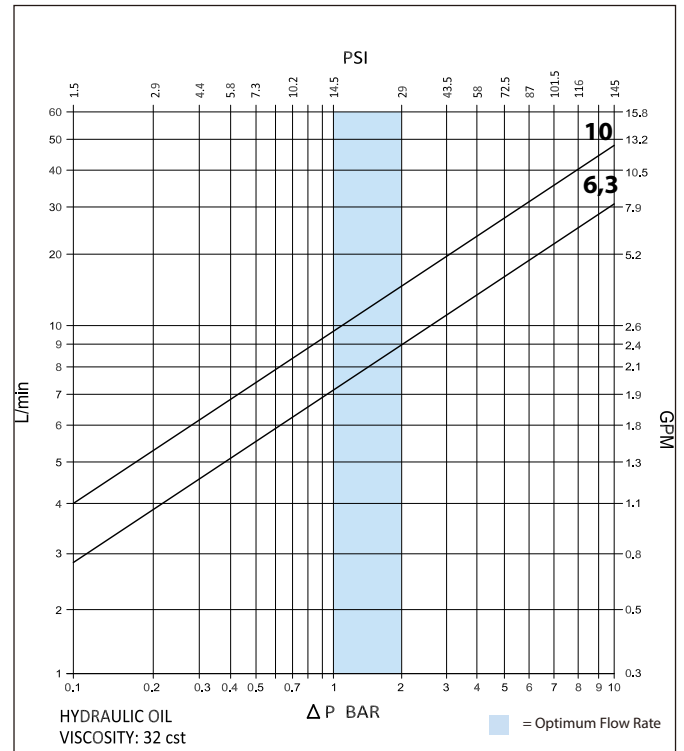

Size	Thread Size (A)	B	C	D	ØE	F	G	ØH	ØI	ØJ	Maximum Working Pressure	Burst Pressure (coupled)	Burst Pressure (Male)	Burst Pressure (Female)				
											Dimensions in mm				Bar			
											Dimensions in inches				Psi			
HJB-6,3	1/4" NPT	19	22	32.5	28.5	60	73.5	28	25.5	16	720	2160	1440	1400				
		0.7	0.9	1.3	1.1	2.4	2.9	1.1	1	0.6	10440	31320	20880	20300				
HJB-10	3/8" NPT	32	25	35	34	73.5	83.5	35	28.5	19	720	2160	1440	1400				
		1.3	1	1.4	1.3	2.9	3.3	1.4	1.1	0.7	10440	31320	20880	20300				

Size	Thread Size (A)	B	C	D	ØE	F	G	ØH	ØI	ØJ	Maximum Working Pressure	Burst Pressure (coupled)	Burst Pressure (Male)	Burst Pressure (Female)				
											Dimensions in mm				Bar			
											Dimensions in inches				Psi			
HJP-6,3	1/4" NPT	19	22	32.5	28.5	60	73.5	28	25.5	16	1000	2160	2160	2100				
		0.7	0.9	1.3	1.1	2.4	2.9	1.1	1	0.6	14500	31320	31320	30450				
HJP-10	3/8" NPT	32	25	35	34	73.5	83.5	35	28.5	19	1000	2160	2160	2100				
		1.3	1	1.4	1.3	2.9	3.3	1.4	1.1	0.7	14500	31320	31320	30450				