

IA2 Series

ISO A couplers made to the ISO 7241:2023 Series A Standard

Introduction

AKJia's IA2 series is another ISO A, general-purpose, double shut-off, fluid transfer quick coupling available with a leakfree, high-flow poppet valve similar to our IA Series. It also complies with ISO 7241 Series A. They are used predominantly in Europe and is preferred worldwide for agricultural and forestry machinery, and body size of 1/2 and 3/4 also reach the additional dimension requirements covered in ISO 5675. The Appearance is similar to the Faster NV series, with sizes from 1/4" to 1" .

Construction

- Carbon steel with trivalent plating
- Zinc Nickel Plating is option
- Fitted with Nitrile seals (NBR) ,FKM option

Features

- Optional zinc nickel plating provides corrosion resistance (1200 hours with no red rust in salt spray tests)
- Poppet valves have balanced springs
- Locking ball system allows quick connection
- Bidirectional flow

Application

- Agricultural
- Mobile
- Construction
- General industrial



Product Number Naming Rules

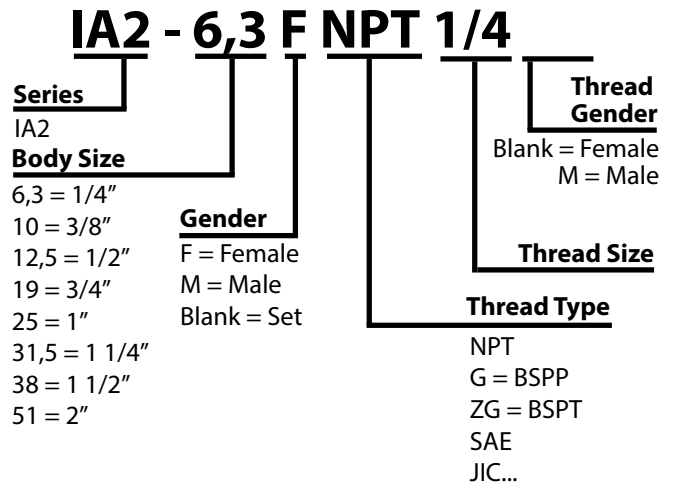

Specifications

| Seal Material | Min. Temp | | Max. Temp | |
|-------------------|-----------|-------|-----------|-------|
| Nitrile seals* | -40°C | -40°F | 106°C | 223°F |
| FKM (Viton) seals | -20°C | -4°F | 200°C | 392°F |

Hydraulic Quick Coupling

Comlock Quick Coupling

Ball Valves

Drawing

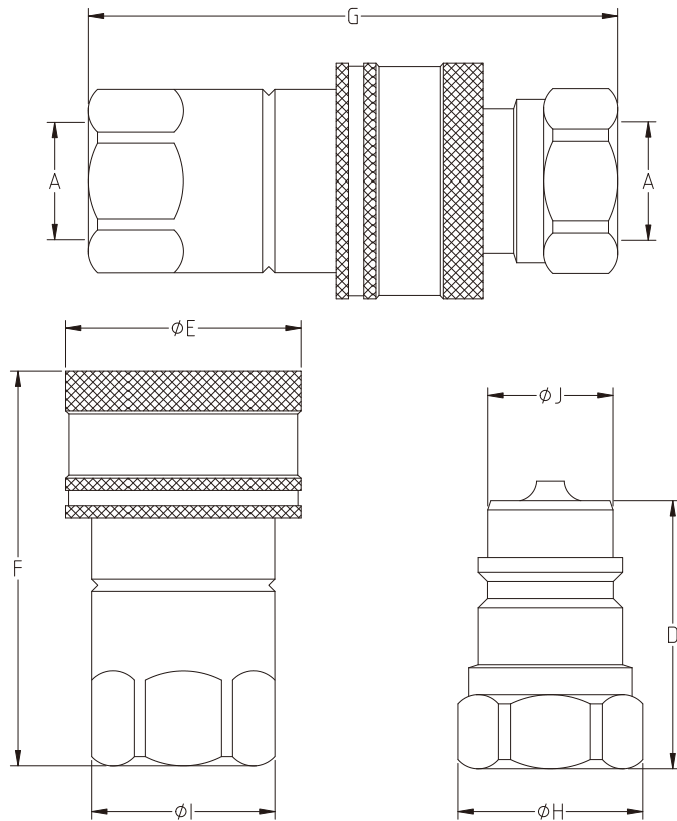

Pressure Drop Characteristics

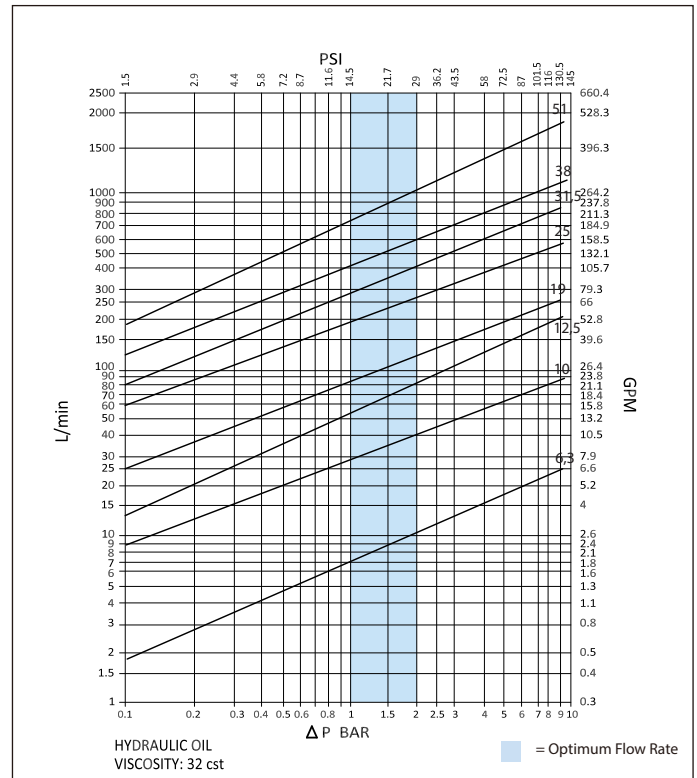

| Size | Thread Size (A) | B | C | D | ØE | F | G | ØH | ØI | ØJ | Maximum Working Pressure | Burst Pressure (coupled) | Burst Pressure (Male) | Burst Pressure (Female) |
|----------------------|-----------------|-----|-----|------|------|------|-------|------|------|------|--------------------------|--------------------------|-----------------------|-------------------------|
| Dimensions in mm | | | | | | | | | | | Bar | | | |
| Dimensions in inches | | | | | | | | | | | Psi | | | |
| IA2-6,3 | 1/4" | 19 | 19 | 35.5 | 26 | 49.5 | 71 | 21 | 21 | 11.8 | 400 | 2200 | 1900 | 1800 |
| | | 0.7 | 0.7 | 1.4 | 1 | 1.9 | 2.8 | 0.8 | 0.8 | 0.5 | 5800 | 31900 | 27550 | 26100 |
| IA2-10 | 3/8" | 22 | 22 | 36.5 | 31.5 | 56 | 75 | 24 | 24 | 17.2 | 350 | 1800 | 1700 | 1600 |
| | | 0.9 | 0.9 | 1.4 | 1.2 | 2.2 | 3 | 0.9 | 0.9 | 0.7 | 5075 | 26100 | 24650 | 23200 |
| IA2-12,5 | 1/2" | 27 | 27 | 43.5 | 38.5 | 66 | 88 | 30 | 30 | 20.5 | 320 | 1500 | 1500 | 1400 |
| | | 1.1 | 1.1 | 1.7 | 1.5 | 2.6 | 3.5 | 1.2 | 1.2 | 0.8 | 4640 | 21750 | 21750 | 20300 |
| IA2-19 | 3/4" | 35 | 35 | 57 | 47 | 80 | 111 | 38 | 38 | 29 | 300 | 1300 | 1300 | 1200 |
| | | 1.4 | 1.4 | 2.2 | 1.9 | 3.1 | 4.4 | 1.5 | 1.5 | 1.1 | 4350 | 18850 | 18850 | 17400 |
| IA2-25 | 1" | 41 | 41 | 60 | 55.5 | 94 | 120 | 44.5 | 44.5 | 34.2 | 250 | 1200 | 1100 | 1000 |
| | | 1.6 | 1.6 | 2.4 | 2.2 | 3.7 | 4.7 | 1.8 | 1.8 | 1.3 | 3625 | 17400 | 15950 | 14500 |
| IA2-31,5 | 1 1/4" | 50 | 50 | 75 | 69 | 117 | 150 | 56 | 56 | 45 | 250 | 1200 | 1200 | 1150 |
| | | 2 | 2 | 3 | 2.7 | 4.6 | 5.9 | 2.2 | 2.2 | 1.8 | 3625 | 17400 | 17400 | 16675 |
| IA2-38 | 1 1/2" | 60 | 60 | 83.5 | 84 | 131 | 168.5 | 63 | 66 | 55 | 230 | 1000 | 1000 | 900 |
| | | 2.4 | 2.4 | 3.3 | 3.3 | 5.2 | 6.6 | 2.5 | 2.6 | 2.2 | 3335 | 14500 | 14500 | 13050 |
| IA2-51 | 2" | 75 | 75 | 105 | 99 | 165 | 211.5 | 83 | 83 | 65 | 170 | 800 | 800 | 750 |
| | | 3 | 3 | 4.1 | 3.9 | 6.5 | 8.3 | 3.3 | 3.3 | 2.6 | 2465 | 11600 | 11600 | 10875 |