



IA SERIES

ISO A COUPLERS MADE TO THE ISO 7241:2023 SERIES A STANDARD

AKJia's IA Series ISO A couplers are the ideal choice where a tough, durable product of superior quality is required. They are perfectly suited to agricultural and industrial applications. ISO 7241 standard specifies two series of the dimensional requirements of the connection parts, IA series follows the dimensional specifications of A series. It makes different brands of quick connectors can be interchanged. Other dimensions may vary. Usually the length and maximum diameter will have some influence in some applications.

Series IA // Carbon Steel

Material	Carbon Steel
Surface Finishing	Zinc-Nickel, Zinc-Plating
Standard Seal Material(s)	NBR (Buna-N®) ²
Working Temperature	-25° C ... +100° C / -13° F ... +212° F
Valve Design	Poppet Valve
Connection	Push and actuate Push Sleeve
Disconnection	Actuate Push Sleeve
Connect Under Pressure	not allowed
Application	Agricultural and Forestry Machinery, Mobile, Construction
ISO Interchange	ISO 7241-1, Series A

² Alternative seal materials are available on request.

Features

- Accepts ISO 7241-1, Series A compliant nipples
- Poppet valves and a metal perch to maintain valve alignment and prevent flow checking
- Coupler sleeve and nipple body are hardened to be damage resistant
- Protective zinc plating with clear trivalent chromate finish
- Locking ball system allows quick connection

Applications

- Truck trailer connections
- Mobile applications
- Attachments
- Agricultural and Forestry Machinery
- Construction
- general industrial

Technical Data

Series	DN Inch	DN Metric	Q _{max}		Working Pressure		bursting pressure coupled		female body		male tip		spillage ml
			l/min	US GPM	bar	psi	bar	psi	bar	psi	bar	psi	
IA-06	1/4"	6,3	17	4.49	350	5076	1400	20305	1700	24656	1500	21756	0.5
IA-10	3/8"	10	46	12.15	275	3989	1500	21756	1500	21756	1400	20305	1.9
IA-12	1/2"	12,5	90	23.77	275	3989	1200	17404	1400	20305	1000	14504	2.7
IA-19	3/4"	19	190	50.19	200	2901	1000	14504	1500	21756	900	13053	9.3
IA-25	1"	25	280	73.97	200	2901	1000	14504	1000	14504	1300	18855	16.0
IA-31	1 1/4"	31,5	480	126.80	200	2901	1000	14504	850	12328	1100	15954	30.0
IA-38	1 1/2"	38	757	199.98	130	1885	820	11893	800	11603	800	11603	54.0
IA-51	2"	51	1000	264.17	130	1885	1000	14504	960	13924	650	9427	120.0

Flow Characteristics

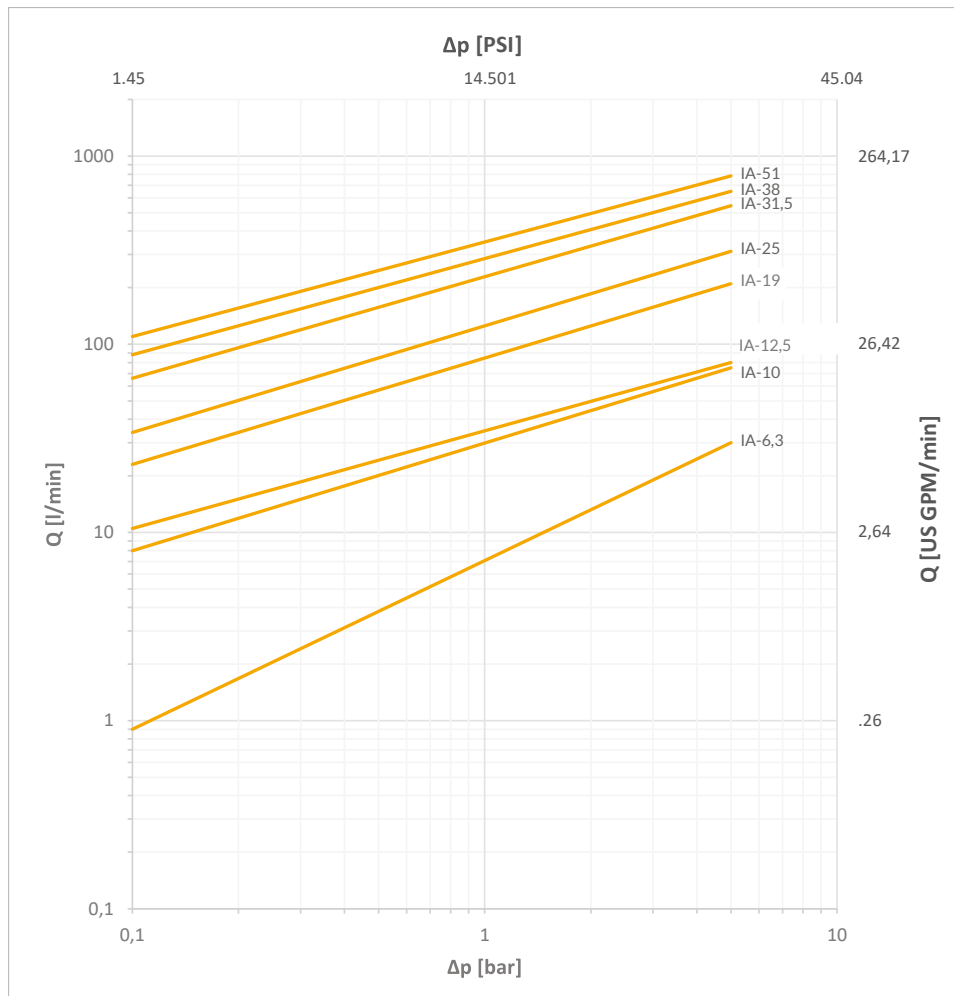

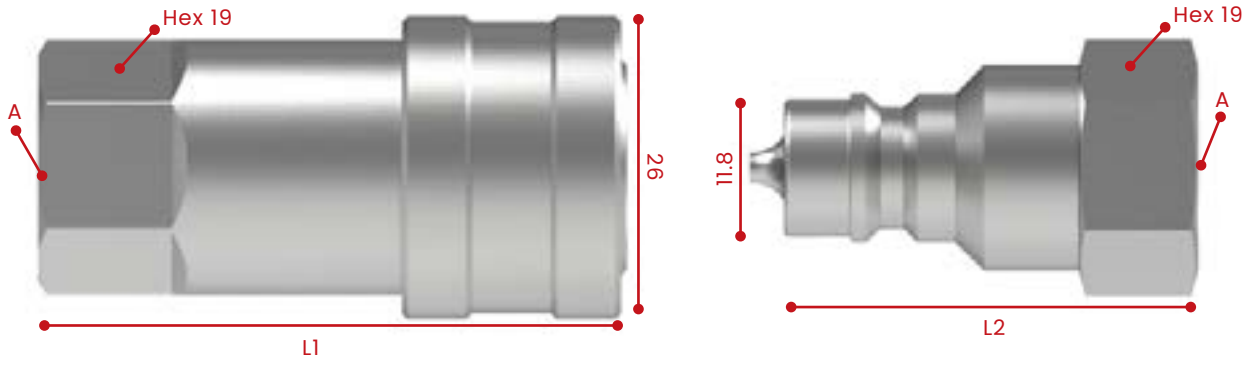

Series IA - 06 / Nominal Size 6,3

	Port A	Dimensions				Female Body	Weight(g)	Male Tip	Weight(g)
		L1	L2	L3	L4				
Female Thread According to DIN3852 - ANSI B 1.20.3 - SAE J1926-1									
	G 1/4"	49.2	35		12	IA-06 F G1/4	106	IA-06 M G1/4	37
	NPT 1/4"-18	49.2	35			IA-06 F NPT1/4	107	IA-06 M NPT1/4	38
	ZG 1/4"	49.2	35			IA-06 F ZG1/4	107	IA-06 M ZG1/4	38
	9/16"-18 UNF	49.2	35			IA-06 F U9/16	102	IA-06 M U9/16	34

•connected length: L1+L2-13.7

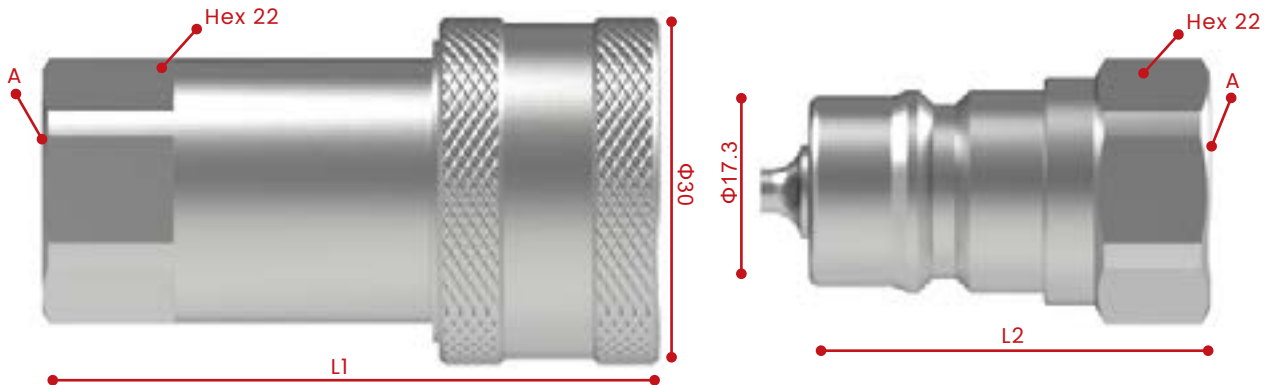

Series IA - 10 / Nominal Size 10

	Port A	Dimensions				Female Body	Weight(g)	Male Tip	Weight(g)
		L1	L2	L3	L4				
Female Thread According to DIN3852 - ANSI B 1.20.3 - SAE J1926-1									
	G 3/8"	60.5	42.5		12	IA-10 F G3/8	155	IA-10 M G3/8	59
	NPT 3/8"-18	60.5	42.5			IA-10 F NPT3/8	156	IA-10 M NPT3/8	60
	UNF 9/16"-18	60.5	42.5		12.7	IA-10 F U9/16	175	IA-10 M U9/16	79
	UNF 3/4"-16	60.5	42.5		14.3	IA-10 F U3/4	184	IA-10 M U3/4	63

•connected length: L1+L2-18

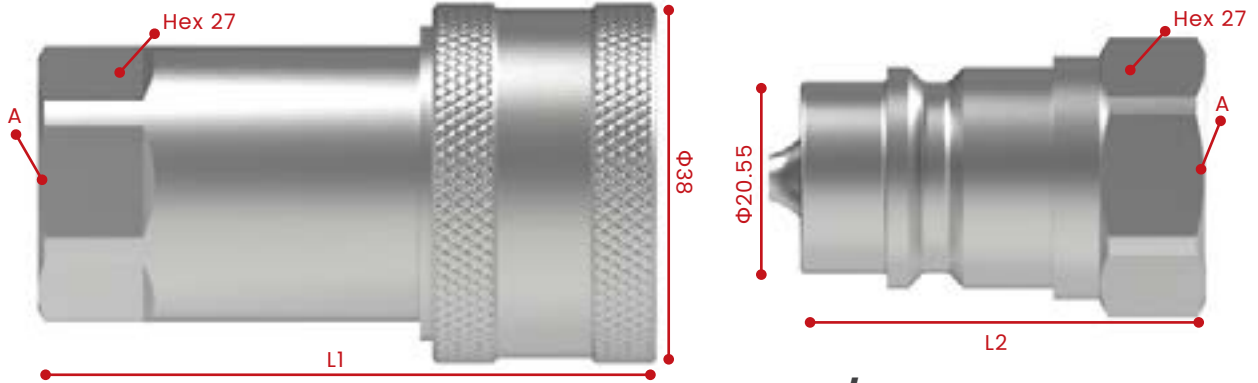

Series IA - 12 / Nominal Size 12,5

	Port A	Dimensions				Female Body	Weight(g)	Male Tip	Weight(g)
		L1	L2	L3	L4				
Female Thread According to DIN3852 - ANSI B 1.20.3 - SAE J1926-1									
	G 1/2"	70	48		14	IA-12 F G1/2	268	IA-12 M G1/2	97
	NPT 1/2"-14	70	48			IA-12 F NPT1/2	269	IA-12 M NPT1/2	98
	NPT 3/4"-14	70	48			IA-12 F NPT3/4	353	IA-12 M NPT3/4	98
	M22x1.5	70	48		15.5	IA-12 F M22	260	IA-12 M M22	90
	UNF 3/4"-16	70	48		14.3	IA-12 F U3/4	274	IA-12 M U3/4	101
	UNF 7/8"-14	70	48		16.7	IA-12 F U7/8	260	IA-12 M U7/8	101

•connected length: L1+L2-10.5

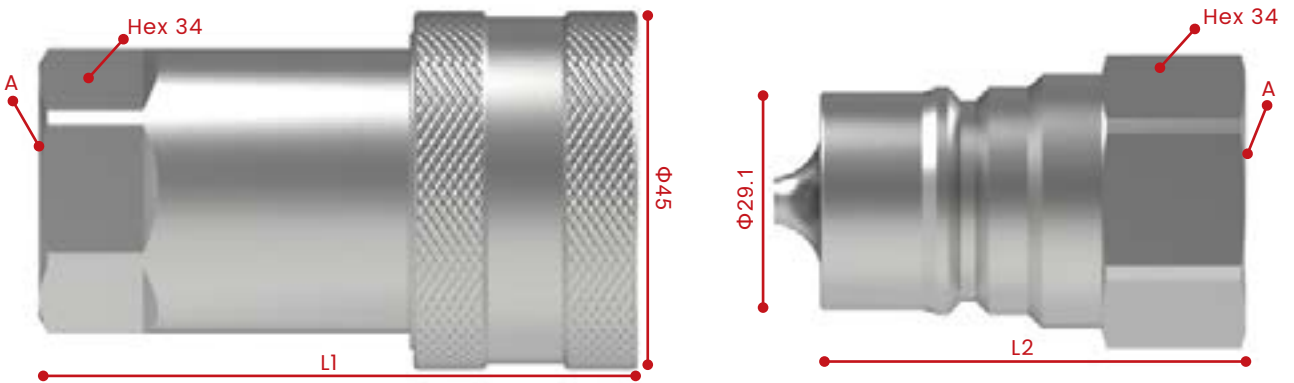

Series IA - 19 / Nominal Size 19

	Port A	Dimensions				Female Body	Weight(g)	Male Tip	Weight(g)
		L1	L2	L3	L4				
Female Thread According to DIN3852 - ANSI B 1.20.3 - SAE J1926-1									
	G 3/4"	84.3	57		16	IA-19 F G3/4	428	IA-19 M G3/4	180
	NPT 3/4"-14	84.3	57			IA-19 F NPT3/4	434	IA-19 M NPT3/4	186

•connected length: L1+L2-15.7

Push To Connect

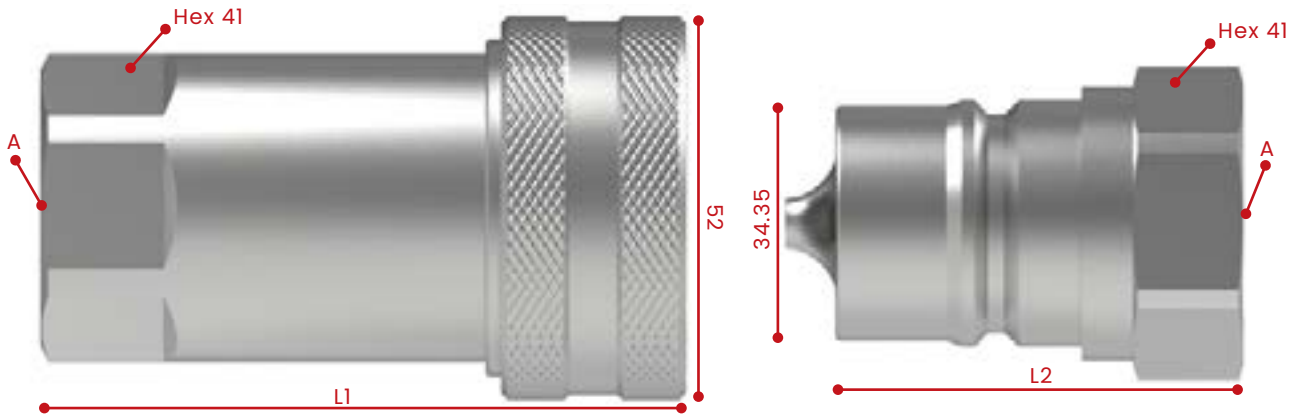

Series IA - 25 / Nominal Size 25

	Port A	Dimensions				Female Body	Weight(g)	Male Tip	Weight(g)
		L1	L2	L3	L4				
Female Thread According to DIN3852 - ANSI B 1.20.3 - SAE J1926-1									
	G 1"	101	67.5		18	IA-25 F G1	700	IA-25 M G1	308
	NPT 1"-11 1/2	101	67.5			IA-25 F NPT1	708	IA-25 M NPT1	313

•connected length: L1+L2-10.5

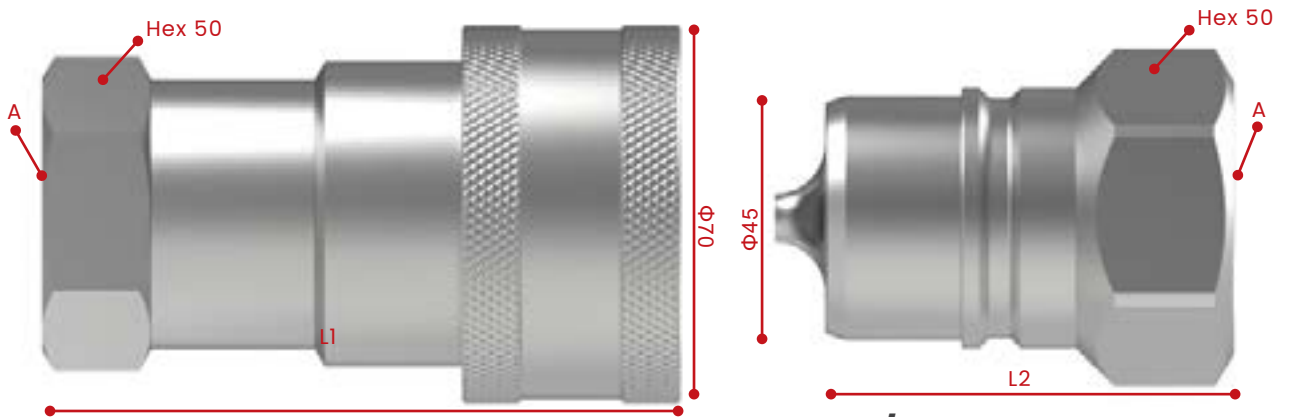

Series IA - 31 / Nominal Size 31.5

	Port A	Dimensions				Female Body	Weight(g)	Male Tip	Weight(g)
		L1	L2	L3	L4				
Female Thread According to DIN3852 - ANSI B 1.20.3 - SAE J1926-1									
	G 1 1/4"	116.9	75		20	IA-31 F G1 1/4	1515	IA-31 M G1 1/4	559
	NPT 1 1/4"-11 1/2	116.9	75			IA-31 F NPT1 1/4	1532	IA-31 M NPT1 1/4	572

•connected length: L1+L2-15.7

Push To Connect

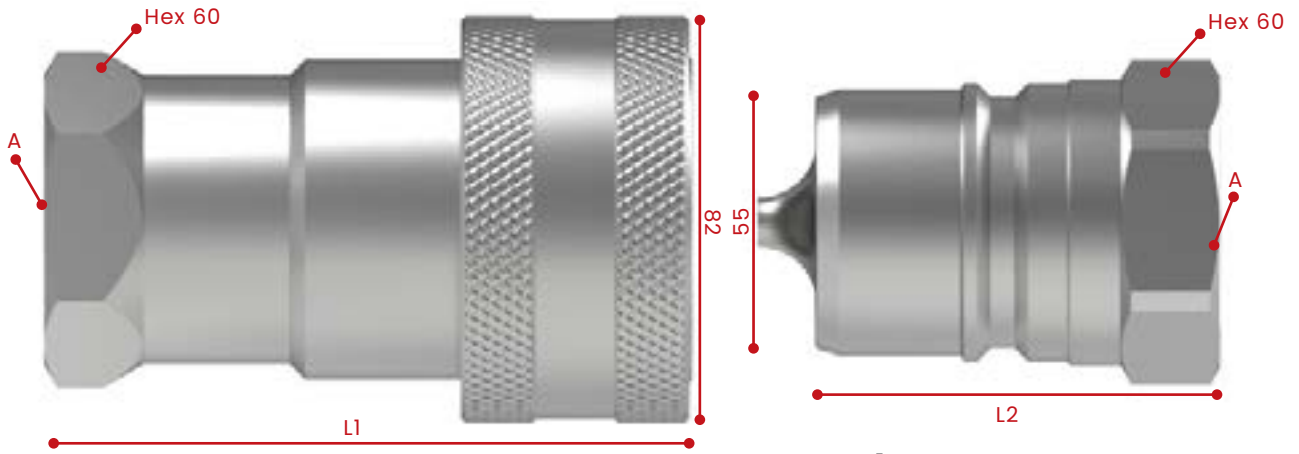

Series IA - 38 / Nominal Size 38

	Port A	Dimensions				Female Body	Weight(g)	Male Tip	Weight(g)
		L1	L2	L3	L4				
Female Thread According to DIN3852 - ANSI B 1.20.3 - SAE J1926-1									
	G 1 1/2"	133	83.5	22	IA-38 F G1 1/2	2445	IA-38 M G1 1/2	918	
	NPT 1 1/2"-11 1/2	133	83.5		IA-38 F NPT1 1/2	2464	IA-38 M NPT1 1/2	938	

•connected length: L1+L2-10.5

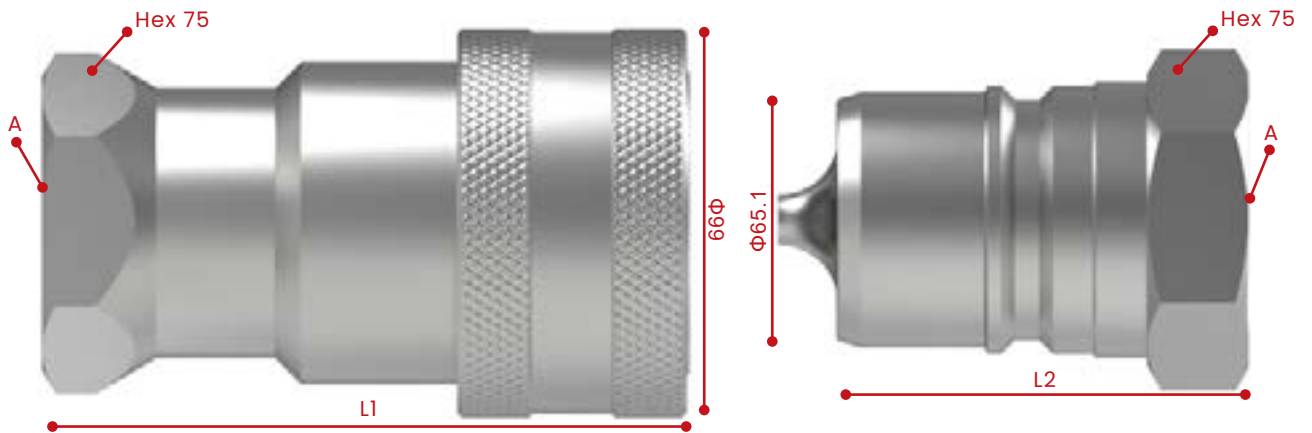

Series IA - 51 / Nominal Size 51

	Port A	Dimensions				Female Body	Weight(g)	Male Tip	Weight(g)
		L1	L2	L3	L4				
Female Thread According to DIN3852 - ANSI B 1.20.3 - SAE J1926-1									
	G 2"	169	108	24	IA-51 F G2	500	IA-51 M G2	180.40	
	NPT 2"-11 1/2	169	108		IA-51 F NPT2	501	IA-51 M NPT2	182	

•connected length: L1+L2-15.7