



IA SERIES

ISO A COUPLERS MADE TO THE ISO 7241:2023 SERIES A STANDARD

AKJia's IA Series ISO A couplers are the ideal choice where a tough, durable product of superior quality is required. They are perfectly suited to agricultural and industrial applications. ISO 7241 standard specifies two series of the dimensional requirements of the connection parts, IA series follows the dimensional specifications of A series. It makes different brands of quick connectors can be interchanged. Other dimensions may vary. Usually the length and maximum diameter will have some influence in some applications.

Series IA // Carbon Steel

Material	Carbon Steel
Surface Finishing	Zinc-Nickel, Zinc-Plating
Standard Seal Material(s)	NBR (Buna-N®) ²
Working Temperature	-25° C ... +100° C / -13° F ... +212° F
Valve Design	Poppet Valve
Connection	Push and actuate Push Sleeve
Disconnection	Actuate Push Sleeve
Connect Under Pressure	not allowed
Application	Agricultural and Forestry Machinery, Mobile, Construction
ISO Interchange	ISO 7241-1, Series A

² Alternative seal materials are available on request.

Features

- Accepts ISO 7241-1, Series A compliant nipples
- Poppet valves and a metal perch to maintain valve alignment and prevent flow checking
- Coupler sleeve and nipple body are hardened to be damage resistant
- Protective zinc plating with clear trivalent chromate finish
- Locking ball system allows quick connection

Applications

- Truck trailer connections
- Mobile applications
- Attachments
- Agricultural and Forestry Machinery
- Construction
- general industrial

Technical Data

Series	DN Inch	DN Metric	Q _{max}		Working Pressure		bursting pressure coupled		female body		male tip		spillage ml
			l/min	US GPM	bar	psi	bar	psi	bar	psi	bar	psi	
IA-06	1/4"	6,3	17	4.49	350	5076	1400	20305	1700	24656	1500	21756	0.5
IA-10	3/8"	10	46	12.15	275	3989	1500	21756	1500	21756	1400	20305	1.9
IA-12	1/2"	12,5	90	23.77	275	3989	1200	17404	1400	20305	1000	14504	2.7
IA-19	3/4"	19	190	50.19	200	2901	1000	14504	1500	21756	900	13053	9.3
IA-25	1"	25	280	73.97	200	2901	1000	14504	1000	14504	1300	18855	16.0
IA-31	1 1/4"	31,5	480	126.80	200	2901	1000	14504	850	12328	1100	15954	30.0
IA-38	1 1/2"	38	757	199.98	130	1885	820	11893	800	11603	800	11603	54.0
IA-51	2"	51	1000	264.17	130	1885	1000	14504	960	13924	650	9427	120.0

Flow Characteristics

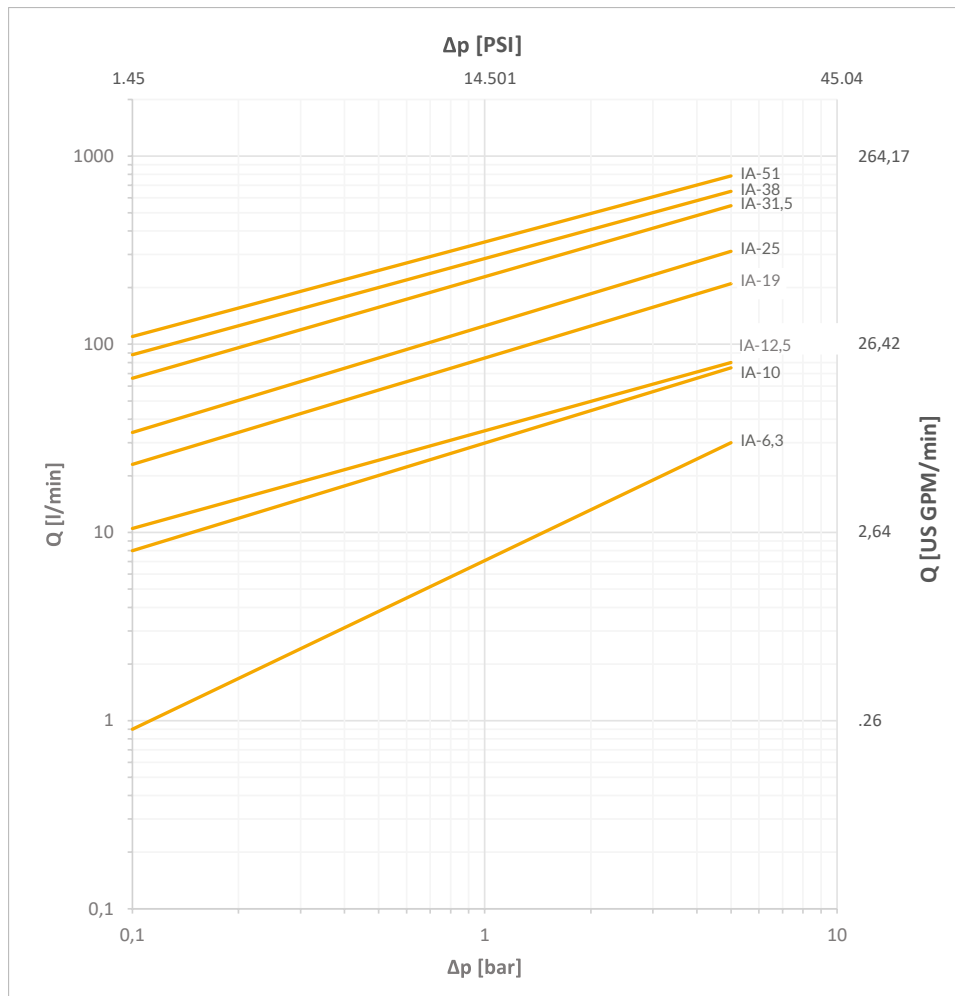

Dimensions

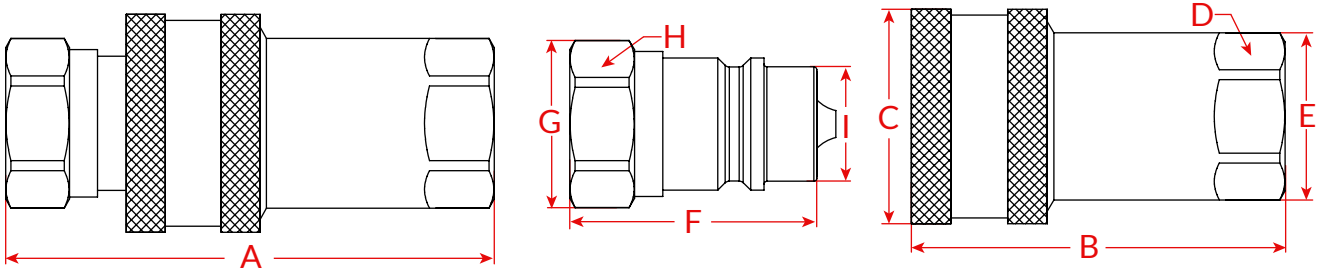

Series	Size	Thread	Overall Length	F Length		Hex		O.D		M Length		O.D		Weight (g)	
				A	B	C	D	E	F	G	H	I	Female	Male	
IA-06	1/4"	1/4"	71	49.5	26	19	21	35.5	21	19	11.8	106	37		
IA-10	3/8"	3/8"	75	56	31.5	22	24	36.5	24	22	17.2	155	59		
IA-12	1/2"	1/2"	88	66	38.5	27	30	43.5	30	27	20.5	268	97		
IA-19	3/4"	3/4"	111	80	47	35	38	57	38	35	29	428	180		
IA-25	1"	1"	120	94	55.5	41	44.5	60	44.5	41	34.2	700	304		
IA-31	1 1/4"	1 1/4"	150	117	69	50	56	75	56	50	45	1510	559		
IA-38	1 1/2"	1 1/2"	168.5	131	84	60	63	83.5	63	60	55	2445	918		
IA-51	2"	2"	211.5	165	99	75	83	105	83	75	65	5000	1804		

Dimensions in mm

Dimensions and weights are based on NPT internal threads. For data on other threads, please contact us. Or view data on specific products on our website.

Code Rules

IA - 10 F NPT3/8

① ② ③ ④

- ① Series - IA
- ② Body Size, 06 = 1/4", 10 = 3/8"...51=2"
- ③ Part, F = Female Coupler, M = Male Nipple, Blank = Set(Female+Male)
- ④ Thread Type and Size, NPT3/8, G3/8 etc. If the male thread, it will have a M after the thread. For example NPT3/8 M

Dust Caps



Size	Female Body	Male Tip	Size	Female Body	Male Tip
1/4"	DC-IA-06 F	DC-IA-06 M	1"	DC-IA-25 F	DC-IA-25 M
3/8"	DC-IA-10 F	DC-IA-10 M	1 1/4"	DC-IA-31 F	DC-IA-31 M
1/2"	DC-IA-12 F	DC-IA-12 M	1 1/2"	DC-IA-38 F	DC-IA-38 M
3/4"	DC-IA-19 F	DC-IA-19 M	2"	DC-IA-51 F	DC-IA-51 M

IA Series dust caps are plastic material, the color can be green, blue, yellow, and black, and the default is red. we also can customized the color as your requirements if your quantity is over 2000 sets. They can also use to other ISO A quick couplings.