



IA3 SERIES

ISO A QUICK COUPLING SIMILAR SAFEWAY S56 APPEARANCE

IA3 Series is a special appearance we designed as some customers' requirements. The appearance is similar with SafeWay S56, but we improve the fluid and pressure performance. The ISO 7241 A series standards mainly specify the requirements for connection dimensions to facilitate the interchangeability of quick couplings of different brands. Different manufacturers can change other dimensions according to their own needs. Our original IA series design is more practical. Therefore, it is a cylindrical design. This design is for some customers who need a conical design.



Series IA3 // Carbon Steel

Material	Carbon Steel
Surface Finishing	Zinc-Nickel, Zinc-Plating
Standard Seal Material(s)	NBR (Buna-N®) ²
Working Temperature	-25° C ... +100° C / -13° F ... +212° F
Valve Design	Poppet Valve
Connection	Push and actuate Push Sleeve
Disconnection	Actuate Push Sleeve
Connect Under Pressure	not allowed
Application	Agricultural and Forestry Machinery, Mobile, Construction
ISO Interchange	ISO 7241-1, Series A

² Alternative seal materials are available on request.

Features

- Accepts ISO 7241-1, Series A compliant nipples
- Poppet valves and a metal perch to maintain valve alignment and prevent flow checking
- Coupler sleeve and nipple body are hardened to be damage resistant
- Protective zinc plating with clear trivalent chromate finish
- Locking ball system allows quick connection

Applications

- Truck trailer connections
- Mobile applications
- Attachments
- Agricultural and Forestry Machinery
- Construction
- general industrial



Technical Data

Series	DN Inch	DN Metric	Q _{max}		Working Pressure		bursting pressure coupled		female body		male tip		spillage ml
			l/min	US GPM	bar	psi	bar	psi	bar	psi	bar	psi	
IA3-06	1/4"	6,3	17	4.49	350	5076	1400	20305	1700	24656	1500	21756	0.5
IA3-10	3/8"	10	46	12.15	275	3989	1500	21756	1500	21756	1400	20305	1.9
IA3-12	1/2"	12,5	90	23.77	275	3989	1200	17404	1400	20305	1000	14504	2.7
IA3-19	3/4"	19	190	50.19	200	2901	1000	14504	1500	21756	900	13053	9.3
IA3-25	1"	25	280	73.97	200	2901	1000	14504	1000	14504	1300	18855	16.0

Flow Characteristics

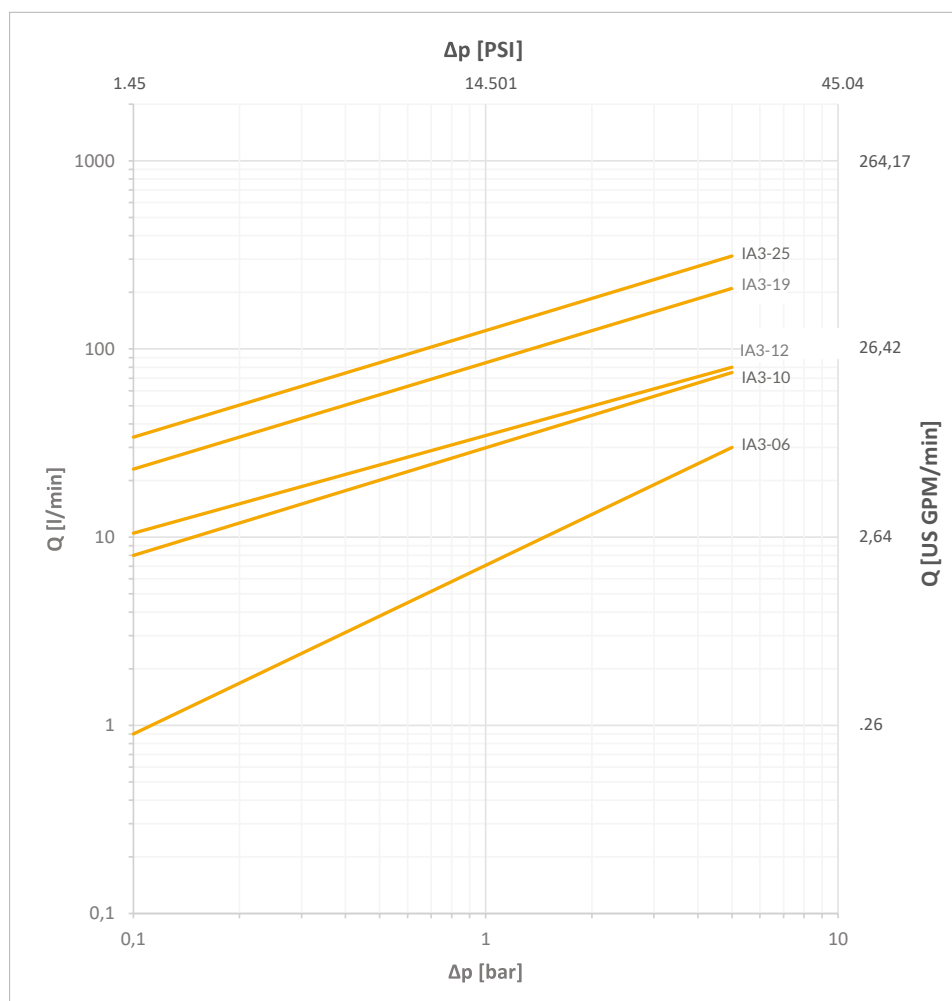

Dimensions

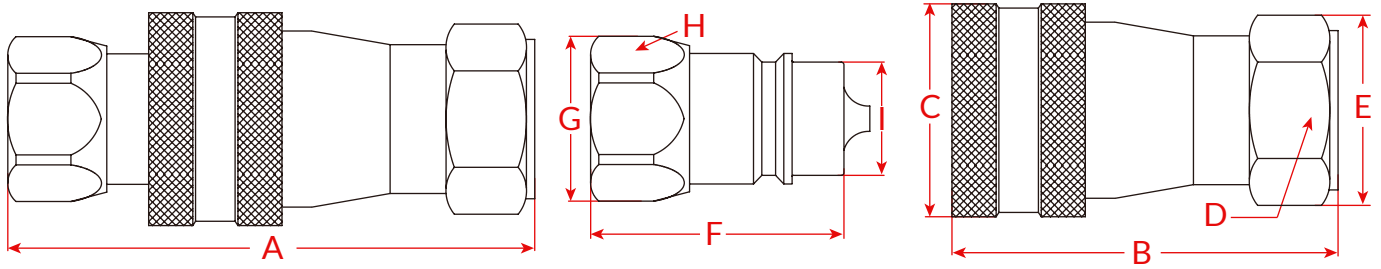

Series	Size	Thread	Overall Length	F Length		Hex		M Length		Hex		Weight (g)	
			A	B	C	D	E	F	G	H	I	Female	Male
IA2-06	1/4"	1/4"	71	49.5	26	19	21	35.5	21	19	11.8	106	37
IA2-10	3/8"	3/8"	75	56	31.5	22	24	36.5	24	22	17.2	155	59
IA2-12	1/2"	1/2"	88	66	38.5	27	30	43.5	30	27	20.5	268	97
IA2-19	3/4"	3/4"	111	80	47	35	38	57	38	35	29	428	180
IA2-25	1"	1"	120	94	55.5	41	44.5	60	44.5	41	34.2	700	304

Dimensions in mm

Dimensions and weights are based on NPT internal threads. For data on other threads, please contact us. Or view data on specific products on our website.

Code Rules

IA3 - 10 F NPT3/8

①
②
③
④

- ① Series - IA3
- ② Body Size, 06 = 1/4", 10 = 3/8"...25=1"
- ③ Part, F = Female Coupler, M = Male Nipple, Blank = Set(Female+Male)
- ④ Thread Type and Size, NPT3/8, G3/8 etc. If the male thread, it will have a M after the thread. For example NPT3/8 M

