



VVS SERIES

Faster VVS interchange Screw to connect for high working pressure applications

VVS Series screw connect couplers are designed for heavy duty applications involving very high pressures and severe pressure pulse conditions.



Series VVS //Carbon Steel

Material	Carbon Steel
Surface Finishing	Zinc-Nickel
Standard Seal Material(s)	NBR (Buna-N®) ²
Working Temperature	-25° C ... +100° C / -13° F ... +212° F
Valve Design	Poppet Valve
Connection	Screw
Disconnection	Screw
Connect Under Pressure	Male Tip or Female Body allowed
Application	Industrial Hydraulic, Rescue and Tensioning Hydraulics
ISO Interchange	-

² Alternative seal materials are available on request.

Features

- Poppet Valve
- Coupling made from carbon steel with Zinc/Nickel surface coating
- Connect under pressure
- Heavy duty internal components
- Wide of range for normal sizes up to DN51 (2")

Applications

- Hydraulic jacks
- Hydraulic hammers
- Construction plant
- Mobile equipment
- Demolition and agricultural industries



Technical Data

Series	DN Inch	DN Metric	Q _{max}		Working Pressure		bursting puresure coupled		female body		male tip		spillage ml
			l/min	US GPM	bar	psi	bar	psi	bar	psi	bar	psi	
VVS-06	1/4"	6.3	17	4.49	800	11600	3000	43511	3000	43511	3000	43511	0.8
VVS-10	3/8"	10	27	7.13	650	9427	3000	43511	3000	43511	3000	43511	1.9
VVS-12	1/2"	12,5	60	15.85	600	8702	2200	31908	2700	39160	2500	36260	2.7
VVS-19	3/4"	19	82.5	21.79	500	7252	2100	30458	2600	37710	2400	34809	9.3
VVS-25	1"	25	150	39.63	460	6672	2000	29008	2600	37710	2300	33359	16
VVS-31	1 1/4"	31,5	210	55.48	360	5221	1500	21756	1500	21756	1500	21756	30
VVS-38	1 1/2"	38	400	105.67	360	5221	1500	21756	1500	21756	1200	17405	54
VVS-51	2"	51	1500	396.26	210	3046	1500	21756	1500	21756	1200	17405	120

Flow Characteristics

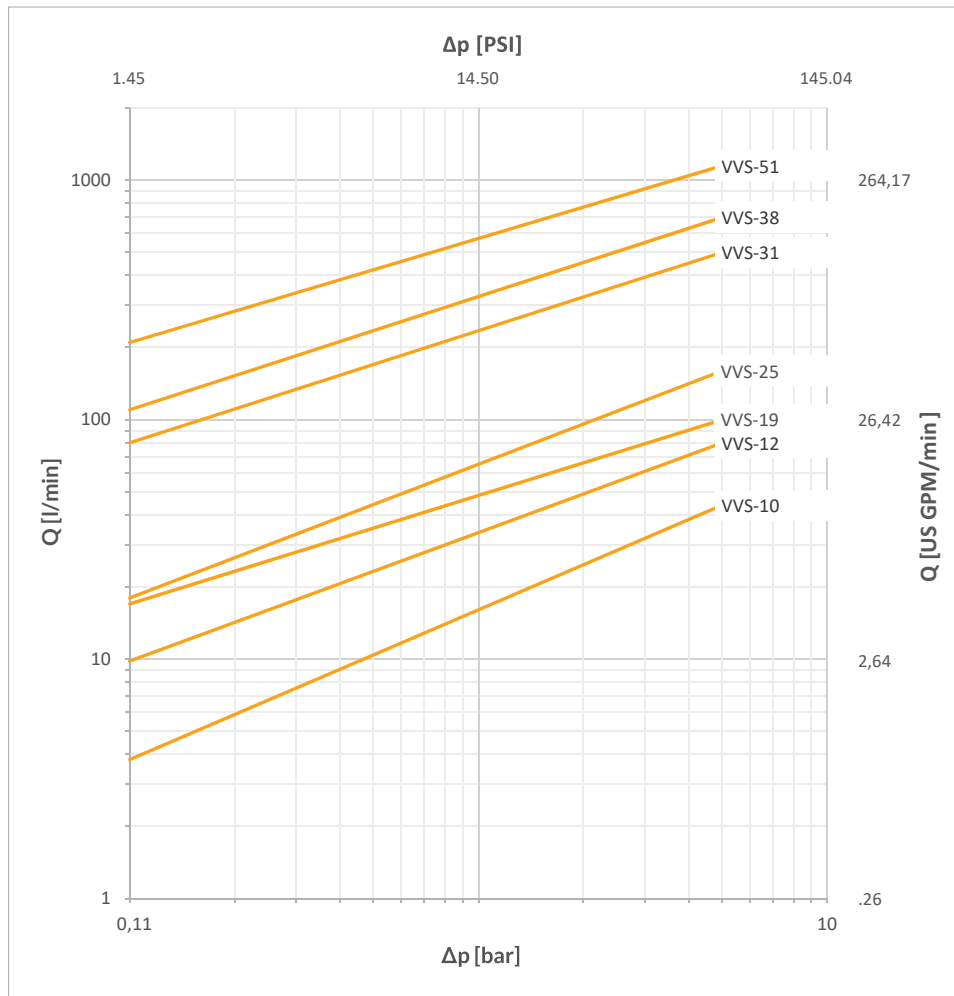

Dimensions

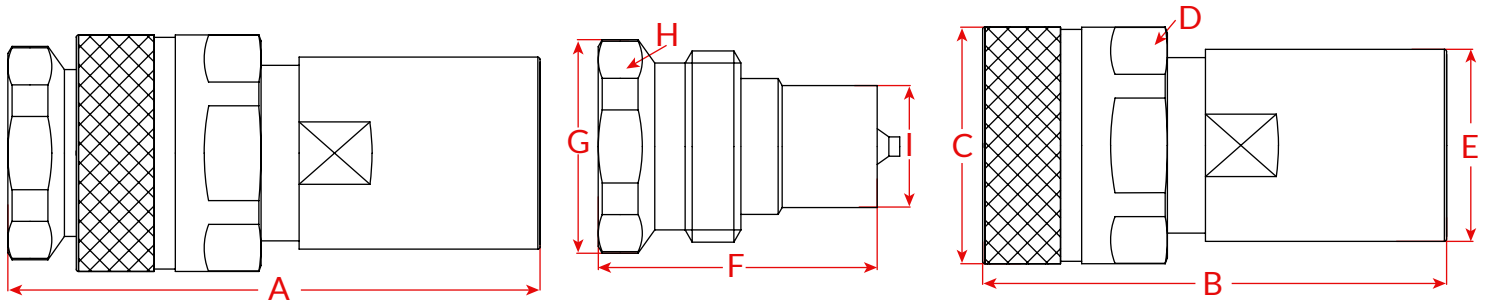

Series	Size	Thread	Overall Length	F. Length	O.D	Hex	O.D	M. Length	O.D	Hex	O.D	Weight (g)	
			A	B	C	D	E	F	G	H	I	Female	Male
VVS-06	1/4"	1/4"	84.5	61.5	30	27	25	43	27	25	14	198	89
VVS-10	3/8"	3/8"	89.5	69	39	36	32	48.5	35	32	19	344	155
VVS-12	1/2"	1/2"	103	79	44	41	38	53	38	34	20.5	576	177
VVS-19	3/4"	3/4"	121.5	97.5	54	50	44	63	48.5	46	28	988	364
VVS-25	1"	1"	139	112.5	59	54.5	54	72.5	54	50	31.5	1405	538
VVS-31	1 1/4"	1 1/4"	167	139.5	80	74.5	69.5	86	70	65	44	2807	1050
VVS-38	1 1/2"	1 1/2"	188	172	98	90	78.5	95	83	80	53.5	4400	1700
VVS-51	2"	2"	228	160	127.5	123	105	118.5	115.5	110	82	8730	4940

Dimensions in mm

The dimensions based on the BSPP Thread, other threads the dimensions would be different, please contact us for more information.

Code Rules

VVS - 10 F G3/8

① ② ③ ④

- ① Series - VVS
- ② Body Size, 06=1/4", 10 =3/8", 12 =1/2", ... 31=1 1/4"
- ③ Part, F = Female Coupler, M = Male Nipple, Blank = Set(Female+Male)
- ④ Thread Type and Size, the default thread is BSPP thread, G3/8", G1/2" etc.

