



AGB SERIES

ISO 5675 AGRICULTURAL QUICK COUPLINGS BALL VALVE

AGB Series couplings are designed with a ball valve for quick connection and disconnection. They are interchangeable with the ISO A couplings in sizes 1/2" and 3/4", and interchangeable with Parker Pioneer quick couplings, widely used in tractors.



Series AGB // Carbon Steel

Material	Carbon Steel
Surface Finishing	Zinc-Nickel, Zinc-Plating
Standard Seal Material(s)	NBR (Buna-N®) ²
Working Temperature	-25° C ... +100° C / -13° F ... +212° F
Valve Design	Ball Valve
Connection	Push and actuate Push Sleeve
Disconnection	Actuate Push Sleeve
Connect Under Pressure	not allowed
Application	Agricultural, Mobile, Construction
ISO Interchange	Only 1/2" Size, ISO 5675

² Alternative seal materials are available on request.

Features

- 1/2" size accepts ISO 5675 universal tips
- Basic operation where coupler sleeve is manually retracted to allow connection with male tip
- Critical parts are hardened
- Ball and poppet valve options
- Protective zinc plating

Applications

- Agricultural
- Hydraulic Loaders
- Add-on hydraulic circuits
- general industrial



Technical Data

Series	DN Inch	DN Metric	Q _{max}		Working Pressure		bursting puresure coupled		female body		male tip		spillage ml
			l/min	US GPM	bar	psi	bar	psi	bar	psi	bar	psi	
AGB-06	1/4"	6,3	18	4.76	400	5081	1700	24656	1400	20305	1600	23206	1
AGB-10	3/8"	10	34.5	9.11	350	5076	1500	21756	1400	20305	1400	20305	2.4
AGB-12	1/2"	12,5	67.5	17.83	250	3626	1520	22046	1250	18130	1000	14504	2.7
AGB-19	3/4"	19	159	42.0	250	3626	1000	14504	1000	14504	750	10878	8.6
AGB-25	1"	25	378	99.86	250	3626	1000	14504	1000	14504	750	10878	13

Flow Characteristics

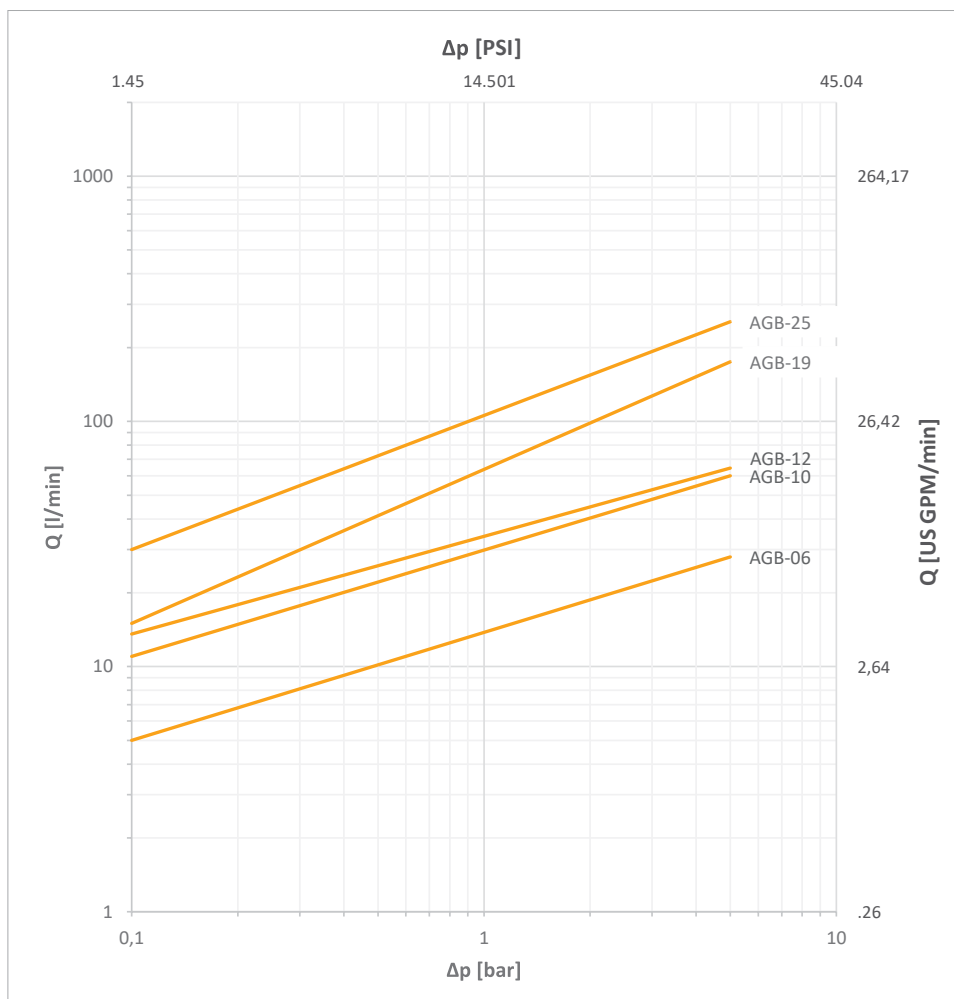

Dimensions

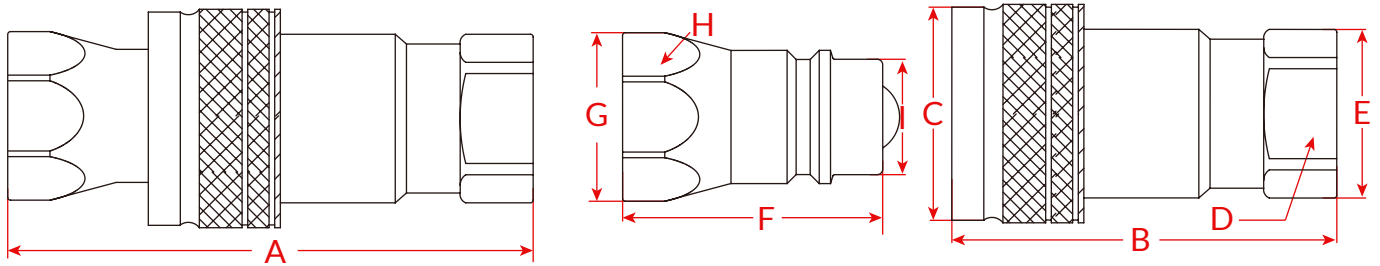

Series	Size	Thread	Overall Length	F Length	O.D	Hex	O.D	M Length	O.D	Hex	O.D	Weight (g)	
			A	B	C	D	E	F	G	H	I	Female	Male
AGB-06	1/4"	1/4"	76.3	55.5	27	19	22	38	22	19	14.2	127	47
AGB-10	3/8"	3/8"	85.5	63	34	24	27	42.5	27	24	19	207	86
AGB-12	1/2"	1/2"	96.5	70	38	27	30	48	30	27	20.55	273	101
AGB-19	3/4"	3/4"	114.5	86	47	34	37	57	37	34	28	494	205
AGB-25	1"	1"	131.5	99	52	41	44	65.5	44	41	31.3	768	302

Dimensions in mm

Dimensions and weights are based on NPT internal threads. The ball valve version usually used in older machines, especially some old brand tractors.

Code Rules

AGB - 12 F NPT1/2

①
②
③
④

- ① Series - AGB
- ② Body Size, 06 = 1/4", 10 = 3/8", 12 = 1/2"...25=1"
- ③ Part, F = Female Coupler, M = Male Nipple, Blank = Set(Female+Male)
- ④ Thread Type and Size, the simple thread like NPT1/2, if Male thread to add a M after the thread, G1/2 M



Dust Caps



Size	Female Body	Male Tip
1/4"	DC-AG-06 F	DC-AG-06 M
3/8"	DC-AG-10 F	DC-AG-10 M
1/2"	DC-IA-12 F	DC-IA-12 M
3/4"	DC-AG-19 F	DC-AG-19 M
1"	DC-AG-25 F	DC-AG-25 M

The AGP and AGB series the dust caps are special design for the agricultural equipment quick couplings, the 1/2" size is same with ISO A dust caps, so can use the IA dust caps, and other dust caps would be AG series, they can be used for AGP and AGB series.

