



FFHP SERIES

HIGH PRESSURE FLAT FACE COUPLERS FITTED WITH A SAFETY LOCKING SLEEVE

AKJia's FFHP Series flat face couplers provide a leak free solution for high pressure applications up to 720 bar. The safety locking sleeve prevents accidental disconnection and can only be disconnected when the release notch and locking ball align.

* It will not connect with lower pressure flush face couplings



Series FFHP //Carbon Steel

Material	Carbon Steel
Surface Finishing	Zinc-Nickel, Zinc-Plating
Standard Seal Material(s)	NBR (Buna-N®), PTFE, ²
Working Temperature	-25° C ... +100° C / -13° F ... +212° F
Valve Design	Flat Face
Connection	Push
Disconnection	Actuate Push Sleeve
Connect Under Pressure	not allowed
Application	High pressure plant and equipment, High pressure pulse applications, Rail industries; especially on de-stressing kits, Bolt tensioning, Cutting tools, Jacking applications
ISO Interchange	ISO 16028

² Alternative seal materials are available on request.

Features

- Rated pressure up to 10,000 psi
- Push to connect operation
- Standard sleeve lock guards against accidental disconnection
- Flat faces are easily wiped clean
- Flat face design prevents fluid loss during disconnection
- Carbon steel with zinc nickel plating (500 hours with no red rust in salt spray tests)

Applications

- Hydraulic crimpers, cutters, benders, clamps, wedges
- Rescue equipment
- High pressure test equipment • Flat faces are easily wiped clean



Technical Data

Series	DN Inch	DN Metric	Q _{max}		Working Pressure		bursting puresure coupled		female body		male tip		spillage ml
			l/min	US GPM	bar	psi	bar	psi	bar	psi	bar	psi	
FFHP-06	1/4"	6,3	24	6.34	720	10440	2000	29000	1500	21750	2000	29000	0.01
FFHP-10	3/8"	10	46	12.16	720	10440	2000	29000	1500	21750	2000	29000	0.015

Flow Characteristics

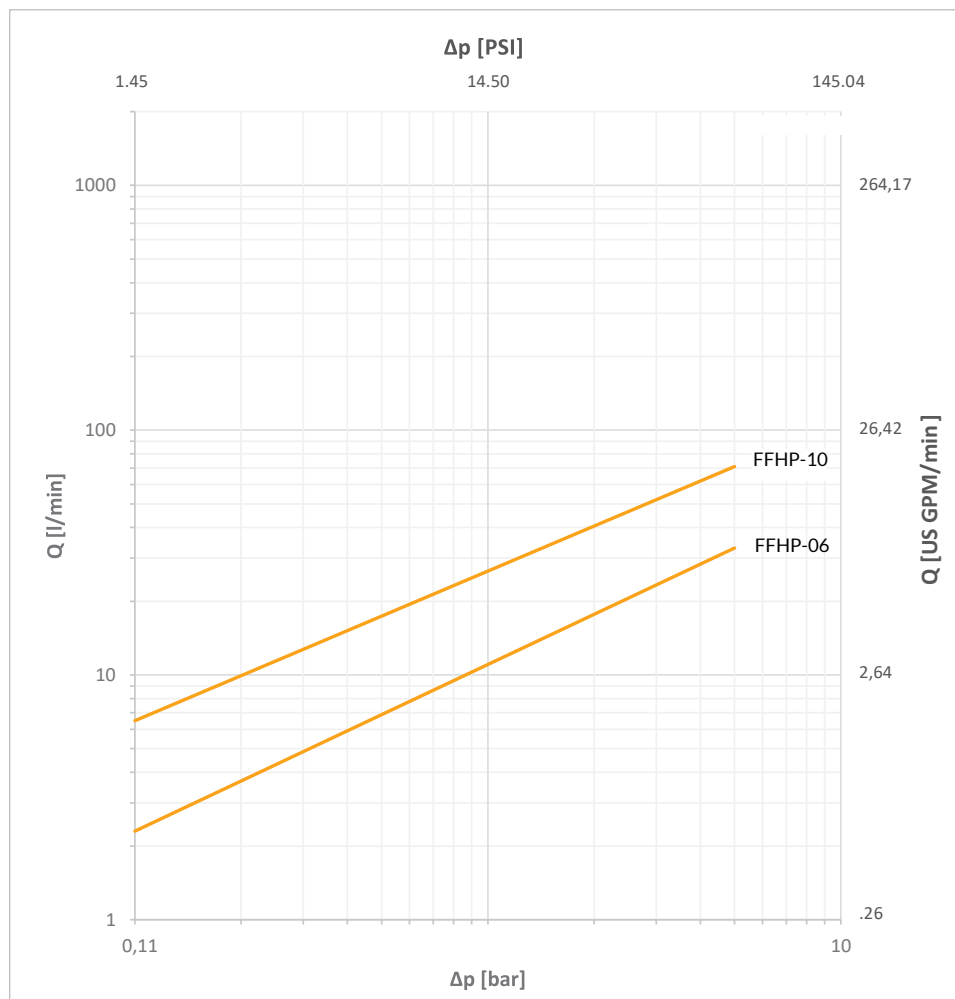

Dimensions

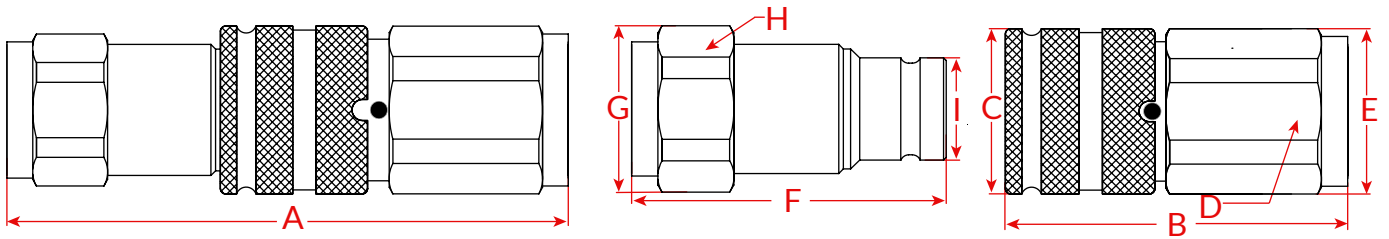

Series	Size	Thread	Overall Length	F Length	O.D	Hex	O.D	M Length	O.D	Hex	O.D	Weight (g)	
			A	B	C	D	E	F	G	H	I	Female	Male
FFS-06	1/4"	1/4"	100	58.5	28	22	24	52	24	22	16.2	181	95
FFS-10	3/8"	3/8"	113.9	73.5	32	30	32	63.5	32	30	19.7	309	200

Dimensions in mm

Dimensions and weights are based on NPT internal threads. For data on other threads, please contact us. Or view data on specific products on our website.

The FFHP series is specially reinforced with materials and can be used in hydraulic applications with a working pressure of 700 bar. It is often used in safety protection applications and high-pressure tool applications.

Code Rules

FFHP - 10 F NPT3/8

①
②
③
④

- ① Series - FFHP
- ② Body Size, 06 = 1/4", 10 = 3/8"
- ③ Part, F = Female Coupler, M = Male Nipple, Blank = Set(Female+Male)
- ④ Thread Type and Size, NPT3/8, G3/8 etc.

