



# HJP SERIES

## High Pressure Screw connect Poppet Quick Coupling Made to ISO 14540

The HJP Series Screw to Connect High Pressure Quick Couplings are expertly designed to comply with the ISO 14540 standard, providing a robust and high-performance solution for demanding hydraulic applications. These couplings are engineered for use in high-pressure environments, offering secure and leak-free connections that are essential for hydraulic jacks, torque wrenches, and other heavy-duty equipment.



## Series HJP // Carbon Steel

Material	Carbon Steel
Surface Finishing	Zinc-Nickel, Zinc-Plating
Standard Seal Material(s)	NBR (Buna-N®), PTFE, <sup>2</sup>
Working Temperature	-25° C ... +100° C / -13° F ... +212° F
Valve Design	Poppet
Connection	Screw sleeve to connect
Disconnection	Screw sleeve
Connect Under Pressure	Can be connected with low residual pressure in the hydraulic circuit
Application	Hydraulic Jacks, Hydraulic Wrenches, High Pressure Hydraulic Applications
ISO Interchange	ISO 14540

<sup>2</sup> Alternative seal materials are available on request.

## Features

- Screw to connect design eliminates brinelling
- Poppet Style Valve
- Can be connected with low residual pressure in the hydraulic circuit
- Coupling made from carbon steel with Zinc/Nickel surface coating
- ISO Interchange acc. to ISO 14540

## Applications

- Hydraulic jacks
- Marine
- Oil and gas
- Agricultural industries



## Technical Data

Series	DN Inch	DN Metric	Q <sub>max</sub>		Working Pressure		bursting pressure coupled		female body		male tip		spillage ml
			l/min	US GPM	bar	psi	bar	psi	bar	psi	bar	psi	
HJP-06	1/4"	6,3	18	4.76	720	10443	2160	31328	2160	31328	2160	31328	0.5
HJP-10	3/8"	10	34.5	9.11	720	10443	2160	31328	2160	31328	2160	31328	1

## Flow Characteristics

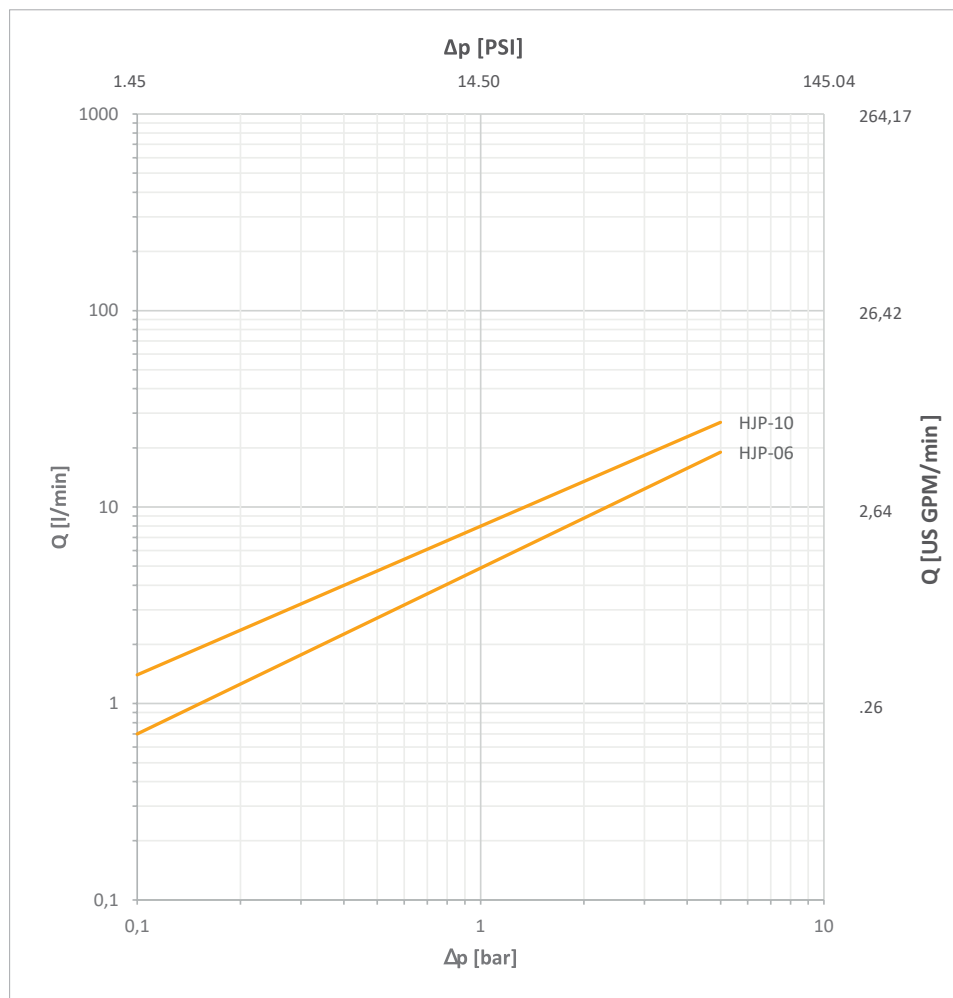

## Dimensions

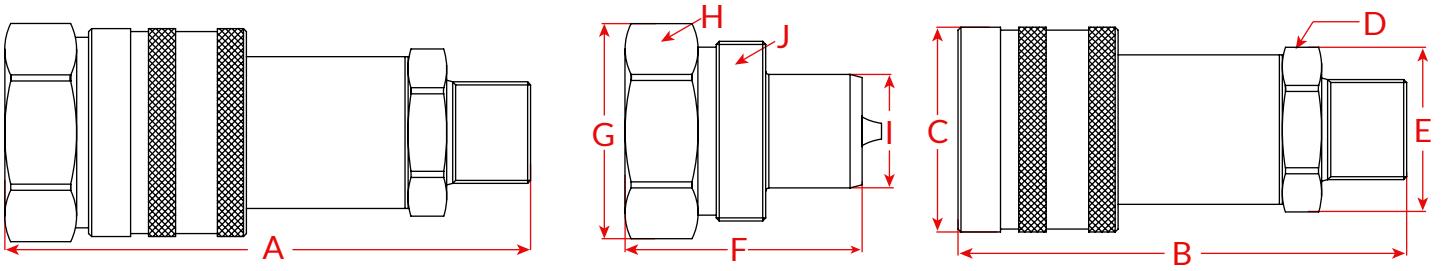

Series	Size	Thread	Overall Length	F. Length	O.D	Hex	O.D	M. Length	O.D	Hex	O.D	Thread	Weight (g)	
			A	B	C	D	E	F	G	H	I	J	Female	Male
HJP-06	1/4"	1/4"	80.6	51.3	30	22	24	40.4	22	19	15.9	1-18 UNS	149	90
HJP-10	3/8"	3/8"	98.3	66.5	35	24	27	42.5	30	27	19	1-3/16-16 UN	249	129

Dimensions in mm

The dimensions based on the npt thread, and the HJP series usually only use the NPT thrad. and the other threads need to customized produced, see the detail product page on our website.

## Code Rules

HJP - 10 F NPT3/8 M

①
②
③
④

- ① Series - HJP
- ② Body Size, 06 = 1/4", 10 = 3/8"
- ③ Part, F = Female Coupler, M = Male Nipple, Blank = Set(Female+Male)
- ④ Thread Type and Size, The default only NPT 1/4 and NPT 3/8

