



HPC SERIES

PARKER TC SERIES INTERCHANGE HIGH PRESSURE APPLICATION COUPLER

AKJia's HPC series is designed to be interchangeable with Parker's TC series high pressure quick connectors. They are used in high pressure applications with hydraulic and mechanical shock. Steel coupler sleeves and nipple bodies are hardened for resistance to damage. Fluorocarbon seals along with PTFE back up rings provide reliable sealing in high pressures. Available in 3/8 inch size only, with sleeve lock to guard against accidental disconnection.



Series HPC // Carbon Steel

Material	Carbon Steel
Surface Finishing	Zinc-Nickel, Zinc-Plating
Standard Seal Material(s)	FKM, PTFE, ²
Working Temperature	-25° C ... +200° C / -13° F ... +392° F
Valve Design	Poppet Valve
Connection	Push and Actuate Push Sleeve
Disconnection	Actuate Push Sleeve
Connect Under Pressure	not allowed
Application	Hydraulic jacking and house moving equipment, Construction equipment, Railway maintenance
ISO Interchange	-

² Alternative seal materials are available on request.

Features

- Rated pressure up to 10,000 psi
- Manual sleeve operation
- Standard sleeve lock guards against accidental disconnection
- Positive valve stop prevents flow checking
- Standard end configuration is female pipe thread
- Available in 3/8 inch size only
- Fluorocarbon seals along with PTFE back up rings provide reliable sealing in high pressures

Applications

- Hydraulic jacking and house moving equipment
- Construction equipment
- Railway maintenance



Technical Data

Series	DN Inch	DN Metric	Q _{max}		Working Pressure		bursting pressure coupled		female body		male tip		spillage
			l/min	US GPM	bar	psi	bar	psi	bar	psi	bar	psi	ml
HPC-10	3/8"	10	23	6	720	10443	2160	31328	2160	31328	2160	31328	1

Flow Characteristics

HPC Series (3/8")
Test Fluid: Oil - 200 SUS

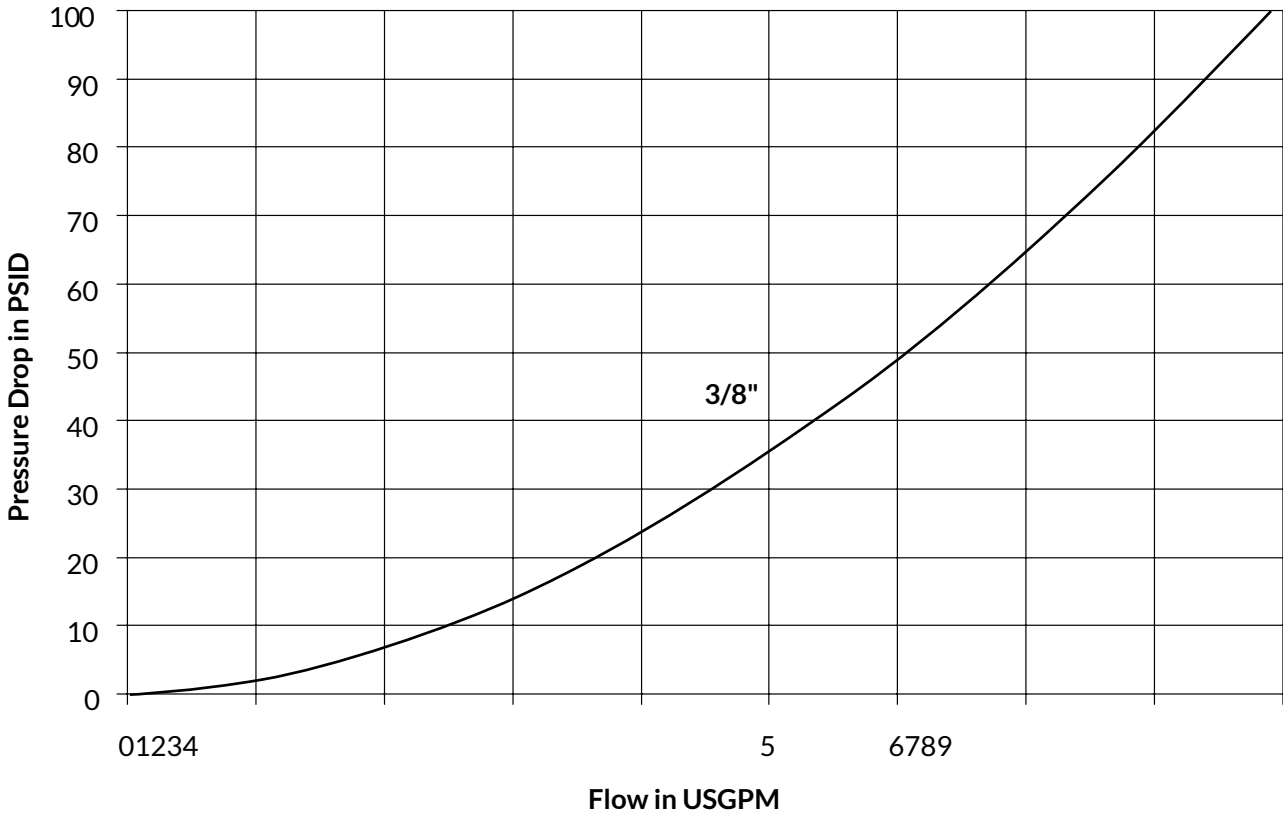

Dimensions

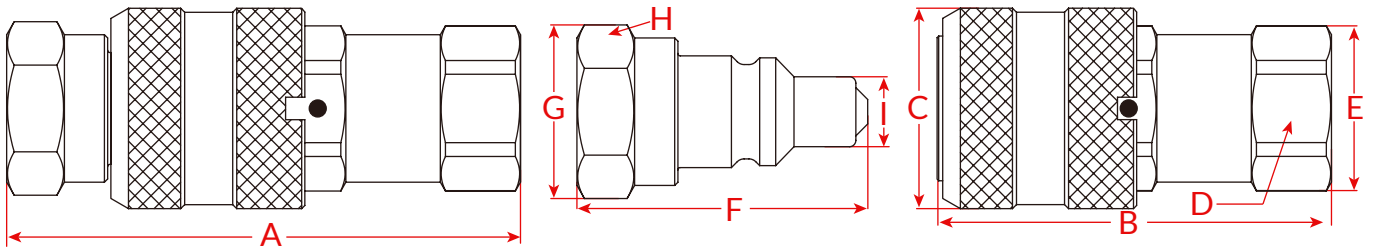

Series	Size	Thread	Overall Length	F Length			M Length			Weight (g)			
				A	B	C	D	E	F	G	H	I	Female
DTP	3/8"	3/8"	79	63	32	24	26	46.2	26	24	11.2	192	61.6

Dimensions in mm

Default 3/8" NPT female thread, and other threads need to customize produced

Code Rules

HPC - 10 F NPT3/8

①
②
③
④

- ① Series - HPC
- ② Body Size, 10 = 3/8"
- ③ Part, F = Female Coupler, M = Male Nipple, Blank = Set(Female+Male)
- ④ Thread Type and Size, the default is NPT3/8 female thread

