



IA2 SERIES

ISO A COUPLER MADE TO ISO 7241:2023 SERIES A STANDARD FASTER ANV SIMILAR APPEARANCE

IA2 series is another ISO A, general-purpose, double shut-off, fluid transfer quick coupling available with a leakfree, high-flow poppet valve similar to our IA Series. It also complies with ISO 7241 Series A. They are used predominantly in Europe and is preferred worldwide for agricultural and forestry machinery, and body size of 1/2 and 3/4 also reach the additional dimension requirements covered in ISO 5675. The Appearance is similar to the Faster ANV series, with sizes from 1/4" to 1".



Series IA2 // Carbon Steel

Material	Carbon Steel
Surface Finishing	Zinc-Nickel, Zinc-Plating
Standard Seal Material(s)	NBR (Buna-N®) ²
Working Temperature	-25° C ... +100° C / -13° F ... +212° F
Valve Design	Poppet Valve
Connection	Push and actuate Push Sleeve
Disconnection	Actuate Push Sleeve
Connect Under Pressure	not allowed
Application	Agricultural and Forestry Machinery, Mobile, Construction
ISO Interchange	ISO 7241-1, Series A

² Alternative seal materials are available on request.

Features

- Accepts ISO 7241-1, Series A compliant nipples
- Poppet valves and a metal perch to maintain valve alignment and prevent flow checking
- Coupler sleeve and nipple body are hardened to be damage resistant
- Protective zinc plating with clear trivalent chromate finish
- Locking ball system allows quick connection
- Faster ANV Appearance similar, with groove design on female coupler

Applications

- Truck trailer connections
- Mobile applications
- Attachments
- Agricultural and Forestry Machinery
- Construction
- general industrial



Technical Data

Series	DN Inch	DN Metric	Q _{max}		Working Pressure		bursting puresure coupled		female body		male tip		spillage ml
			l/min	US GPM	bar	psi	bar	psi	bar	psi	bar	psi	
IA2-06	1/4"	6,3	17	4.49	350	5076	1400	20305	1700	24656	1500	21756	0.5
IA2-10	3/8"	10	46	12.15	275	3989	1500	21756	1500	21756	1400	20305	1.9
IA2-12	1/2"	12,5	90	23.77	275	3989	1200	17404	1400	20305	1000	14504	2.7
IA2-19	3/4"	19	190	50.19	200	2901	1000	14504	1500	21756	900	13053	9.3
IA2-25	1"	25	280	73.97	200	2901	1000	14504	1000	14504	1300	18855	16.0

Flow Characteristics

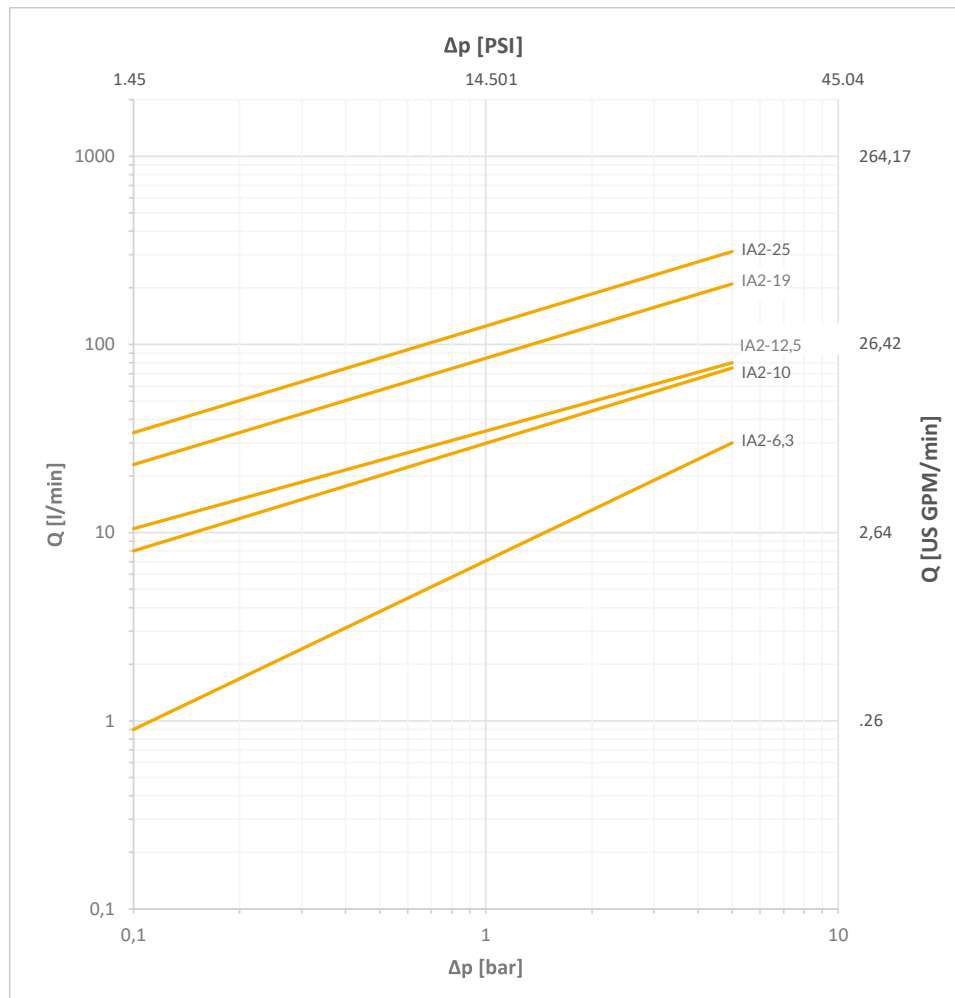

Dimensions

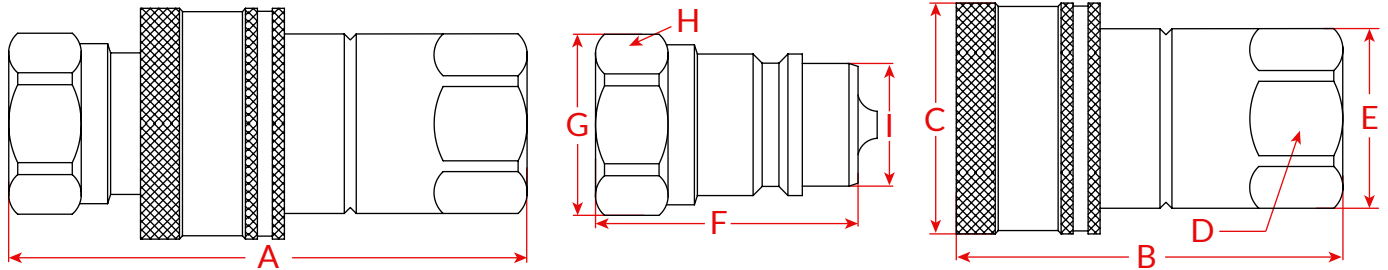

Series	Size	Thread	Overall Length	F Length	O.D	Hex	O.D	M Length	O.D	Hex	O.D	Weight (g)	
			A	B	C	D	E	F	G	H	I	Female	Male
IA2-06	1/4"	1/4"	71	49.5	26	19	21	35.5	21	19	11.8	106	37
IA2-10	3/8"	3/8"	75	56	31.5	22	24	36.5	24	22	17.2	155	59
IA2-12	1/2"	1/2"	88	66	38.5	27	30	43.5	30	27	20.5	268	97
IA2-19	3/4"	3/4"	111	80	47	35	38	57	38	35	29	428	180
IA2-25	1"	1"	120	94	55.5	41	44.5	60	44.5	41	34.2	700	304

Dimensions in mm

Dimensions and weights are based on NPT internal threads. For data on other threads, please contact us. Or view data on specific products on our website.

Code Rules

IA2 - 10 F NPT3/8

①
②
③
④

- ① Series - IA2
- ② Body Size, 06 = 1/4", 10 = 3/8"...25=1"
- ③ Part, F = Female Coupler, M = Male Nipple, Blank = Set(Female+Male)
- ④ Thread Type and Size, NPT3/8, G3/8 etc. If the male thread, it will have a M after the thread. For example NPT3/8 M

