



IAPP SERIES

ISO A "PUSH PULL" QUICK COUPLERS

AKJia's IAPP Series ISO A couplers are designed primarily for the agricultural industries and incorporate a push-pull design. The coupler is panel mounted using circlip grooves in the locking sleeve. The Push Pull hydraulic coupling performs well on installing a hose to connect. They can connect under pressure.



Series IAPP // Carbon Steel

Material	Carbon Steel
Surface Finishing	Zinc-Nickel, Zinc-Plating
Standard Seal Material(s)	NBR (Buna-N®), PTFE, ²
Working Temperature	-25° C ... +100° C / -13° F ... +212° F
Valve Design	Poppet Valve
Connection	Push
Disconnection	Pull
Connect Under Pressure	not allowed
Application	Agricultural and Forestry Machinery
ISO Interchange	ISO 7241-1 A and ISO 5675 (for 1/2" Size).

² Alternative seal materials are available on request.

Features

- Female half available in 'Push Pull' design
- ISO 7241 Series A
- Connects with up to 250 bar residual pressure
- Poppet valves have balanced springs
- Protective zinc plating with clear trivalent chromate finish
- Locking ball system allows quick connection

Applications

- Agricultural
- Mobile applications
- Construction
- general industrial



Technical Data

Series	DN Inch	DN Metric	Q _{max}		Working Pressure		bursting pressure coupled		female body		male tip		spillage ml
			l/min	US GPM	bar	psi	bar	psi	bar	psi	bar	psi	
IAPP-06	1/4"	6,3	20	5.28	250	3626	1000	14504	1000	14504	1000	14504	0.8
IAPP-10	3/8"	10	40	10.57	250	3626	1000	14504	1000	14504	1000	14504	1.2
IAPP-12	1/2"	12.5	100	21.13	250	3626	1000	14504	1000	14504	1000	14504	1.7
IAPP-19	3/4"	19	120	30.70	250	3626	1000	14504	1000	14504	700	10153	8.0
IAPP-25	1"	25	160	42.27	250	3626	1000	14504	1000	14504	700	10153	12.0

Flow Characteristics

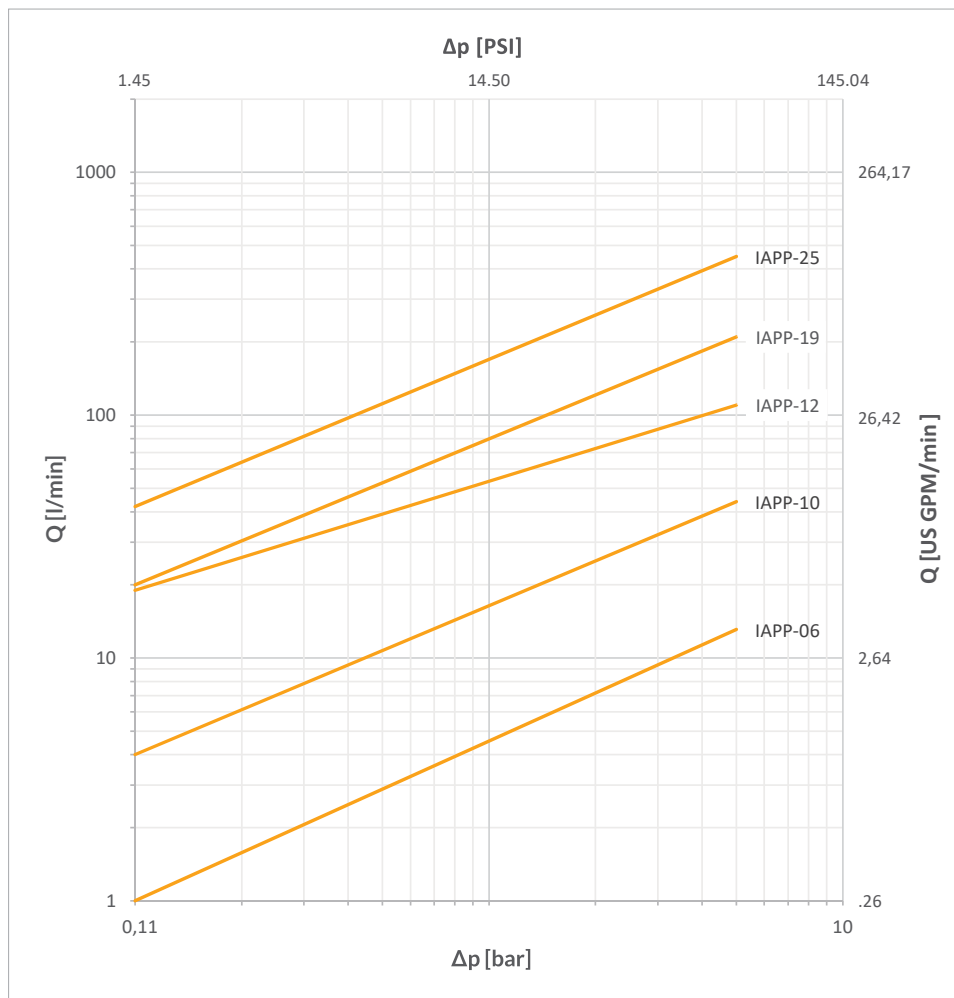

Dimensions

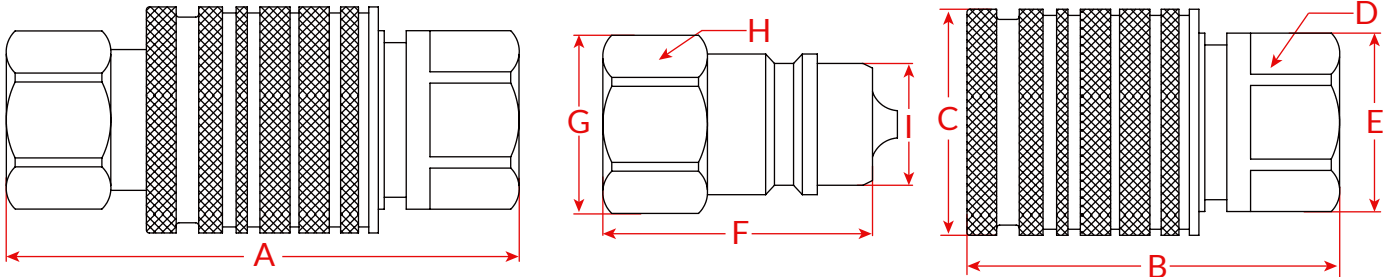

Series	Size	Thread	Overall Length	F Length	O.D	Hex	O.D	M Length	O.D	Hex	O.D	Weight (g)	
			A	B	C	D	E	F	G	H	I	Female	Male
IAPP-06	1/4"	1/4"	91.8	64	26	19	22	45.5	22	19	11.9	147	55
IAPP-10	3/8"	3/8"	98.3	67	31	22	24.5	49	24	22	17.3	195	82
IAPP-12	1/2"	1/2"	109.3	72	38	30	33	59	33	30	20.55	324	166
IAPP-19	3/4"	3/4"	131.3	92.8	46	36	39	58	39	36	29.1	623	288
IAPP-25	1"	1"	142.5	99.5	54	41	44	60	44	41	34.35	853	453

Dimensions in mm

Dimensions and weights are based on NPT internal threads. Different from other Series, the Male thread with 24° cone connector threads ISO 8434-1 is more popular. the detail diemnsions,you can see our website. or just contact us for more information.

Code Rules

IAPP - 12 F 15L M22x1.5 M

①
②
③
④

- ① Series - IAPP
- ② Body Size, 06 = 1/4", 10 = 3/8", 12 = 1/2"...25=1"
- ③ Part, F = Female Coupler, M = Male Nipple, Blank = Set(Female+Male)
- ④ Thread Type and Size, the simple thread like NPT1/2, if Male thread to add a M after the thread, G1/2 M, and the ISO8434-1 there would be a grade code, like 08L M14x1.5, and the bulkhead version thread would add the BK, like 10L BK M16x1.5



Dust Caps



Size	Female Body	Male Tip
1/4"	DC-IA-06 F	DC-IA-06 M
3/8"	DC-IA-10 F	DC-IA-10 M
1/2"	DC-IA-12 F	DC-IA-12 M
3/4"	DC-IA-19 F	DC-IA-19 M
1"	DC-IA-25 F	DC-IA-25 M

The IAPP series also complies with the ISO7241 Series A standard, so the commonly used dust cap is the IA series dust cap, and there are different colors to choose from, blue, green, red, black, yellow, etc. Due to the needs of some customers, we have also developed several AG series, so this type of quick connector can use the AGP dust cap.

