



IBB SERIES

Brass ISO B Quick Couplings Made to ISO 7241:2023 Series B Standard

brass ISO B couplers incorporate all the benefits of the carbon steel IB Series couplers while providing good corrosion resistance for specific applications.



Series IBB //Brass

Material	Brass (Poppet and Ball, stainless steel)
Surface Finishing	No plating
Standard Seal Material(s)	FKM ²
Working Temperature	-25° C ... +200° C / -13° F ... +392° F
Valve Design	Poppet Valve
Connection	Push and actuate Push Sleeve
Disconnection	Actuate Push Sleeve
Connect Under Pressure	not allowed
Application	Cooling systems, Marine, Oil and gas, Chemical, Pharmaceutical, steam
ISO Interchange	ISO 7241-1, Series B

² Alternative seal materials are available on request.

Features

- Accepts ISO 7241-1, Series B compliant nipples
- Poppet valves along with a metal to metal valve stop maintains valve alignment and prevents flow checking
- brass, and stainless steel material
- double O-rings and stainless steel locking balls
- Optional Sleeve-Lok and alternative seal materials available

Applications

- Cooling Systems
- Marine
- Oil and Gas
- Chemical
- Pharmaceutical



Technical Data

Series	DN Inch	DN Metric	Q _{max}		Working Pressure		bursting pressure coupled		female body		male tip		spillage ml
			l/min	US GPM	bar	psi	bar	psi	bar	psi	bar	psi	
IBB-06	1/4"	6,3	24	6.3	200	2901	1200	17404	800	11603	800	11603	1
IBB-10	3/8"	10	46	12.15	200	2901	950	13779	850	12328	800	11603	2.4
IBB-12	1/2"	12,5	90	23.77	180	2611	1000	14504	900	13053	720	10443	3.9
IBB-19	3/4"	19	220	58.12	130	1885	800	11603	650	9427	550	7977	11.0
IBB-25	1"	25	260	68.68	130	1885	600	8702	700	10153	550	7977	19.0
IBB-38	1 1/2"	38	757	199.98	60	870	250	3626	250	3626	250	3626	95.0
IBB-51	2"	51	1000	264.17	50	725	200	2901	200	2908	250	2901	170.0

Flow Characteristics

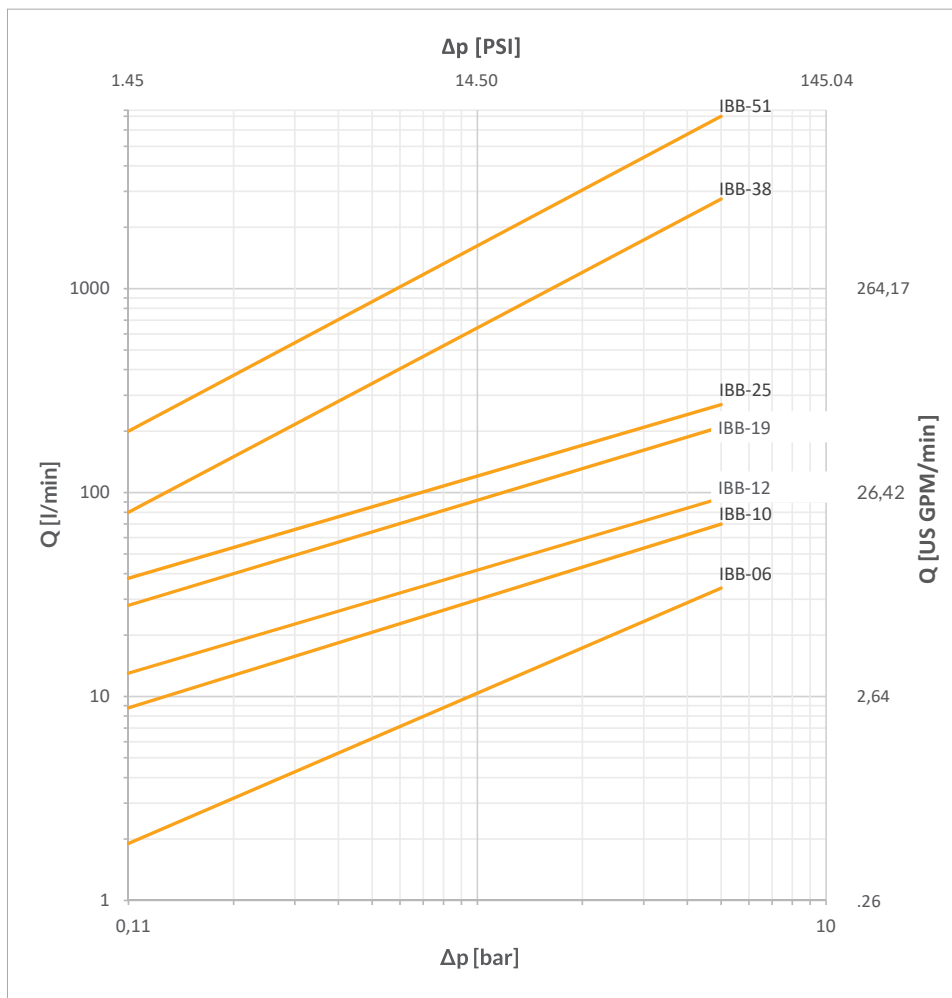

Dimensions

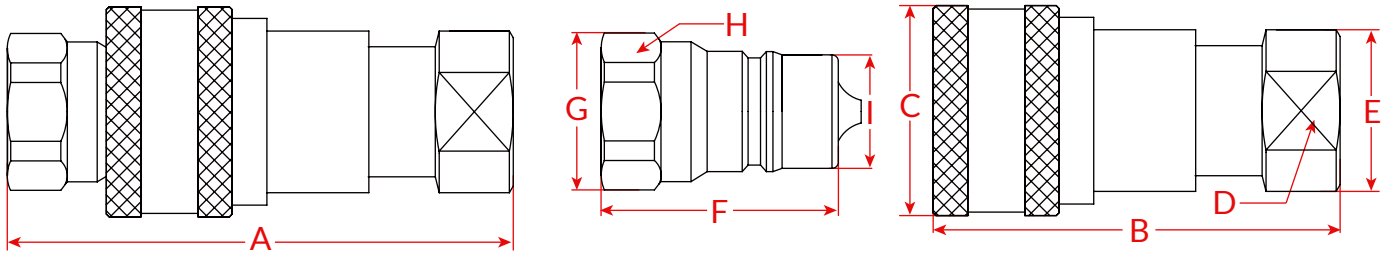

Series	Size	Thread	Overall Length	F Length	O.D	Hex	O.D	M Length	O.D	Hex	O.D	Weight (g)	
			A	B	C	D	E	F	G	H	I	Female	Male
IB-05	1/8"	1/8"	64.1	50.7	23	17	19	32	16	14	10.9	89	20
IB-06	1/4"	1/4"	76.5	60	28	19	21	38	22	19	14.2	133	43
IB-10	3/8"	3/8"	85.5	67.2	35	22	24	42.5	24	22	19.1	213	69
IB-12	1/2"	1/2"	96.5	75.7	44	27	30	48	30	27	23.55	396	124
IB-19	3/4"	3/4"	114.5	91.5	52	34	37	57	37	34	31.45	597	226
IB-25	1"	1"	132	105.8	60	41	44	65.5	44	41	37.77	936	392
IB-38	1 1/2"	1 1/2"	201.5	126.5	78.6	65	68	127	68	65	44.45	2198	1452
IB-51	2"	2"	221	142	105	90	94	142	94	90	63.2	5320	3470

Dimensions in mm

Dimensions and weights are based on NPT internal threads. and for other threads please see the detail product page on our website.

Code Rules

$$\underline{\text{IBB}} - \underline{\text{12}} \underline{\text{F}} \underline{\text{NPT1/2}}$$

①
②
③
④

- ① Series - IBB
- ② Body Size, 05 = 1/8", 06 = 1/4", 10 - 3/8", 12 = 1/2"...51=2"
- ③ Part, F = Female Coupler, M = Male Nipple, Blank = Set(Female+Male)
- ④ Thread Type and Size, the simple thread like NPT1/2, if Male thread to add a M after the thread, G1/2 M



Dust Caps



Size	Female Body	Male Tip
1/4"	DC-IB-06 F	DC-IB-06 M
3/8"	DC-IB-10 F	DC-IB-10 M
1/2"	DC-IB-12 F	DC-IB-12 M
3/4"	DC-IB-19 F	DC-IB-19 M
1"	DC-IB-25 F	DC-IB-25 M

IBB Series is ISO B quick couplings, they can use the same dust caps as IB series, the brass ISO B quick couplings are usually used for water applications or steam applications, so the dust caps are usually not necessary.

