



IBS SERIES

Stainless Steel ISO B Quick Coupling Made to ISO 7241:2023 Series B Standard

IBS Series stainless steel ISO B couplers incorporate all the benefits of the carbon steel IB Series couplers, while being perfectly suited for corrosive fluids and environments.



Series IBS //Stainless Steel

| | |
|---------------------------|---|
| Material | Stainless Steel (SS304 Default, SS316 Option) |
| Surface Finishing | No plating |
| Standard Seal Material(s) | FKM, ² |
| Working Temperature | -25° C ... +200° C / -13° F ... +392° F |
| Valve Design | Poppet Valve |
| Connection | Push and actuate Push Sleeve |
| Disconnection | Actuate Push Sleeve |
| Connect Under Pressure | not allowed |
| Application | Corrosive fluids and environments, Marine, Oil and gas, Chemical, Pharmaceutical, Nuclear |
| ISO Interchange | ISO 7241-1, Series B |

² Alternative seal materials are available on request.

Features

- Accepts ISO 7241-1, Series B compliant nipples
- Poppet valves along with a metal to metal valve stop maintains valve alignment and prevents flow checking
- SUS 304 and SUS316 Stainless Steel Options
- Default FKM Seal Material, and other Seal Material options
- Option locking system preventing unintentional release of the coupling (For BOP Applications)
- All components are stainless steel material

Applications

- Corrosive fluids and environments
- Marine and offshore
- Oil and Gas
- Chemical
- Pharmaceutical
- Nuclear



Technical Data

| Series | DN Inch | DN Metric | Q _{max} | | Working Pressure | | bursting pressure coupled | | female body | | male tip | | spillage ml |
|--------|---------|-----------|------------------|--------|------------------|------|---------------------------|-------|-------------|-------|----------|-------|-------------|
| | | | l/min | US GPM | bar | psi | bar | psi | bar | psi | bar | psi | |
| IBS-05 | 1/8" | 5 | 9 | 2.3 | 300 | 4350 | 900 | 13050 | 900 | 13050 | 1000 | 14500 | 0.5 |
| IBS-06 | 1/4" | 6,3 | 24 | 6.34 | 350 | 5076 | 1600 | 23206 | 1500 | 21756 | 1700 | 24656 | 1.0 |
| IBS-10 | 3/8" | 10 | 46 | 12.15 | 300 | 4351 | 2100 | 30458 | 1100 | 15954 | 1100 | 15954 | 2.4 |
| IBS-12 | 1/2" | 12,5 | 90 | 23.77 | 300 | 4351 | 1500 | 21756 | 1400 | 20305 | 1500 | 21756 | 3.9 |
| IBS-19 | 3/4" | 19 | 220 | 58.12 | 220 | 3191 | 1000 | 14504 | 900 | 13053 | 1000 | 14504 | 11.0 |
| IBS-25 | 1" | 25 | 260 | 68.68 | 200 | 2901 | 850 | 12328 | 650 | 9427 | 600 | 8702 | 19.0 |
| IBS-38 | 1 1/2" | 38 | 757 | 199.98 | 80 | 1160 | 250 | 3626 | 250 | 3626 | 250 | 3626 | 95.0 |
| IBS-51 | 2" | 51 | 1000 | 264.17 | 60 | 870 | 250 | 2901 | 200 | 2901 | 200 | 2901 | 170.0 |

Flow Characteristics

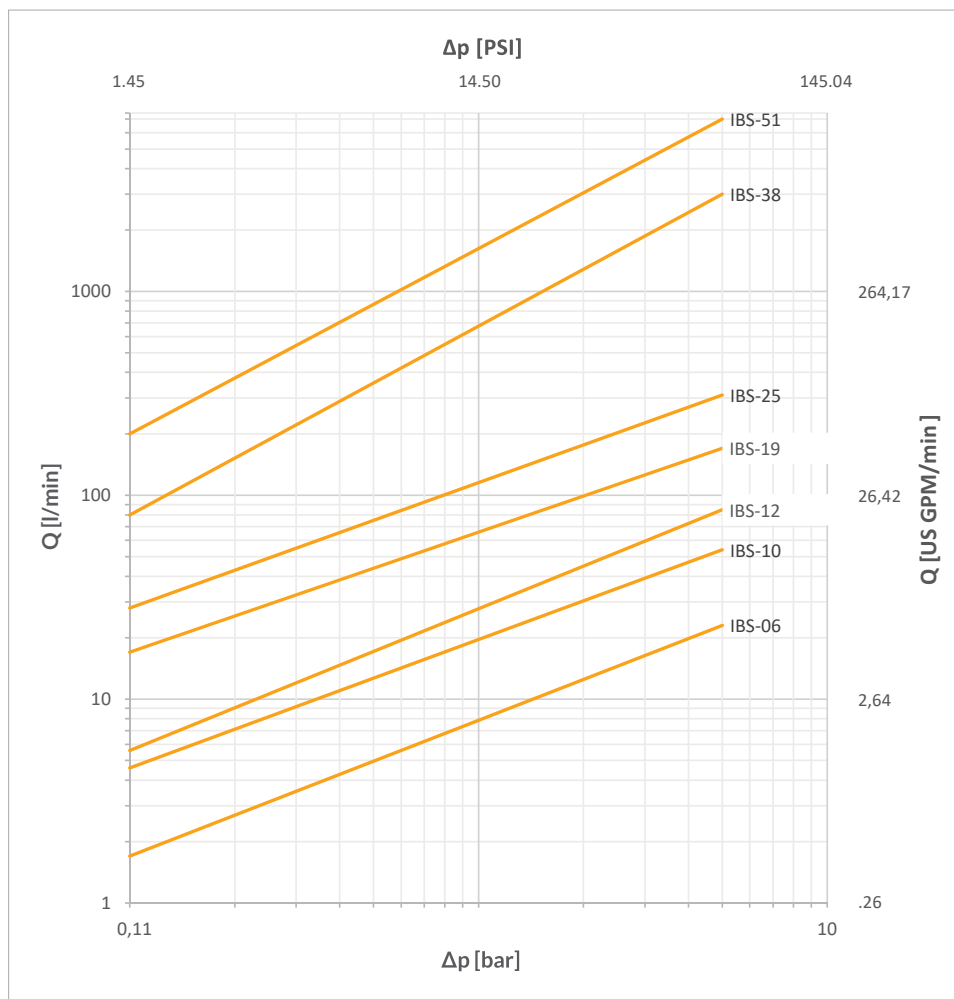

Dimensions

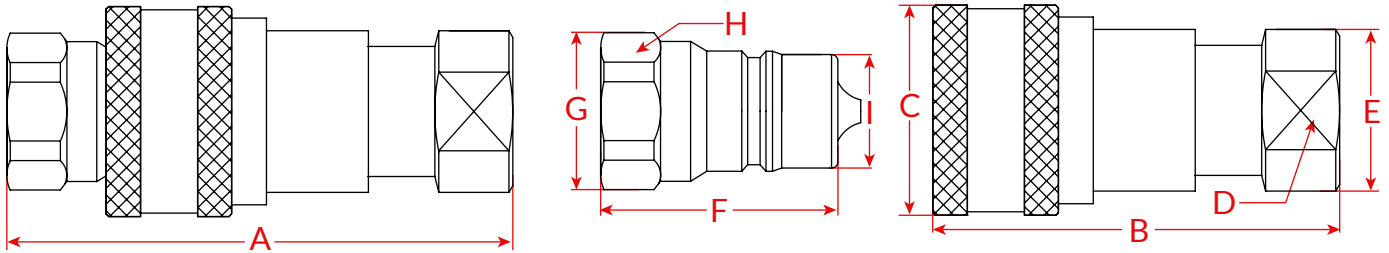

| Series | Size | Thread | Overall Length | F Length | O.D | Hex | O.D | M Length | O.D | Hex | O.D | Weight (g) | |
|--------|--------|--------|----------------|----------|------|-----|-----|----------|-----|-----|-------|------------|------|
| | | | A | B | C | D | E | F | G | H | I | Female | Male |
| IB-05 | 1/8" | 1/8" | 64.1 | 50.7 | 23 | 17 | 19 | 32 | 16 | 14 | 10.9 | 89 | 20 |
| IB-06 | 1/4" | 1/4" | 76.5 | 60 | 28 | 19 | 21 | 38 | 22 | 19 | 14.2 | 130 | 40 |
| IB-10 | 3/8" | 3/8" | 85.5 | 67.2 | 35 | 22 | 24 | 42.5 | 24 | 22 | 19.1 | 197 | 60 |
| IB-12 | 1/2" | 1/2" | 96.5 | 75.7 | 44 | 27 | 30 | 48 | 30 | 27 | 23.55 | 346 | 107 |
| IB-19 | 3/4" | 3/4" | 114.5 | 91.5 | 52 | 34 | 37 | 57 | 37 | 34 | 31.45 | 560 | 210 |
| IB-25 | 1" | 1" | 132 | 105.8 | 60 | 41 | 44 | 65.5 | 44 | 41 | 37.77 | 908 | 342 |
| IB-38 | 1 1/2" | 1 1/2" | 201.5 | 126.5 | 78.6 | 65 | 68 | 127 | 68 | 65 | 44.45 | 2166 | 1382 |
| IB-51 | 2" | 2" | 221 | 142 | 105 | 90 | 94 | 142 | 94 | 90 | 63.2 | 4970 | 3290 |

Dimensions in mm

Dimensions and weights are based on NPT internal threads, and for other threads please see the detail product page on our website.

Code Rules

IBS - 12 F NPT1/2

① ② ③ ④

- ① Series - IBS
- ② Body Size, 05 = 1/8", 06 = 1/4", 10 - 3/8", 12 = 1/2"...51=2"
- ③ Part, F = Female Coupler, M = Male Nipple, Blank = Set(Female+Male)
- ④ Thread Type and Size, the simple thread like NPT1/2, if Male thread to add a M after the thread, G1/2 M

